

# Horn Loudspeakers



*LBC 3481/12*



*LBC 3491/12*



*LBC 3492/12*



*LBC 3493/12*



**Security Systems**

Installation and User Instructions  
LBC 3481/12, LBC 3491/12  
**EN** LBC 3492/12, LBC 3493/12

# BOSCH

## Technical performance data acc. to IEC 268-5

Max. power  
 Rated power (PHC)  
 Sound pressure level at rated power/1 W  
 (at 1 kHz, 1 m)  
 Effective frequency range (-10 dB)  
 Opening angle (at 1 kHz/4 kHz, -6dB)  
 Rated voltage  
 Rated impedance  
 Ambient temperature range  
 Water- and dust protected  
 Safety  
 Connection  
 Dimensions  
     aperture dia.  
     overall length  
 Colour  
 Weight

## LBC 3481/12

15 W  
 10 W (10 - 5 - 2.5 W)  
 113 dB/103 dB (SPL)  
 500 Hz to 7 kHz  
 160°/50°  
 100 V  
 1000 Ω  
 -25 to +55 °C  
 acc. to IEC 60529 IP 65  
 acc. to EN 60065  
 4-wire cable, 2 m long  
 156 mm (6.14 in)  
 184 mm (7.24 in)  
 Light grey (RAL 7035)  
 1.25 kg (2.75 lb)

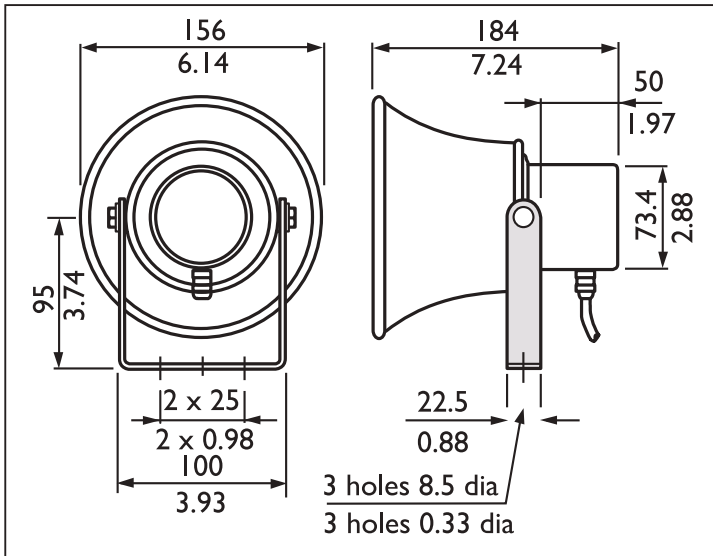

Dimensions (in mm and inches)

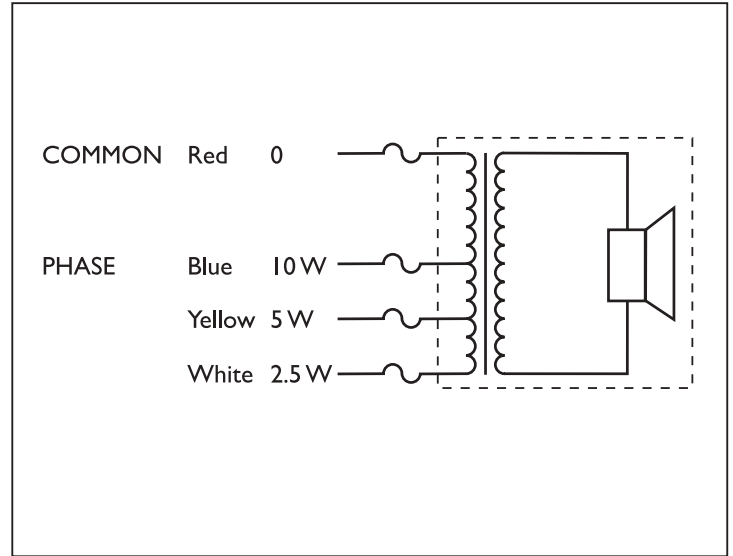

Circuit diagram

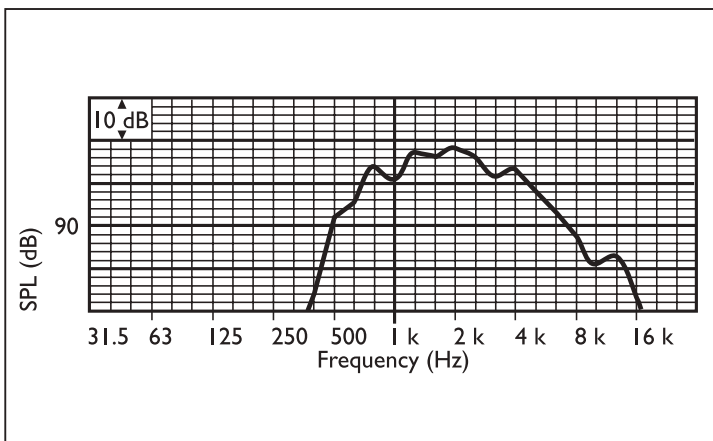

Frequency response

## Technical performance data acc. to IEC 268-5

Max. power  
 Rated power (PHC)  
 Sound pressure level at rated power/1 W  
 (at 1 kHz, 1 m)  
 Effective frequency range (-10 dB)  
 Opening angle (at 1 kHz/4 kHz, -6dB)  
     horizontal  
     vertical  
 Rated voltage  
 Rated impedance  
 Ambient temperature range  
 Water- and dust protected  
 Safety  
 Connection  
 Dimensions  
     aperture  
     overall length  
 Colour  
 Weight

## LBC 3491/12

15 W  
 10 W (10 - 5 - 2.5 W)  
 118 dB/108 dB (SPL)  
 480 Hz to 5.5 kHz  
 90°/40°  
 130°/45°  
 100 V  
 1000 Ω  
 -25 to +55 °C  
 acc. to IEC 60529 IP 65  
 acc. to EN 60065  
 4-wire cable, 2 m long  
 267 x 171 mm (10.51 x 6.73 in)  
 276 mm (10.87 in)  
 Light grey (RAL 7035)  
 1.4 kg (3.08 lb)

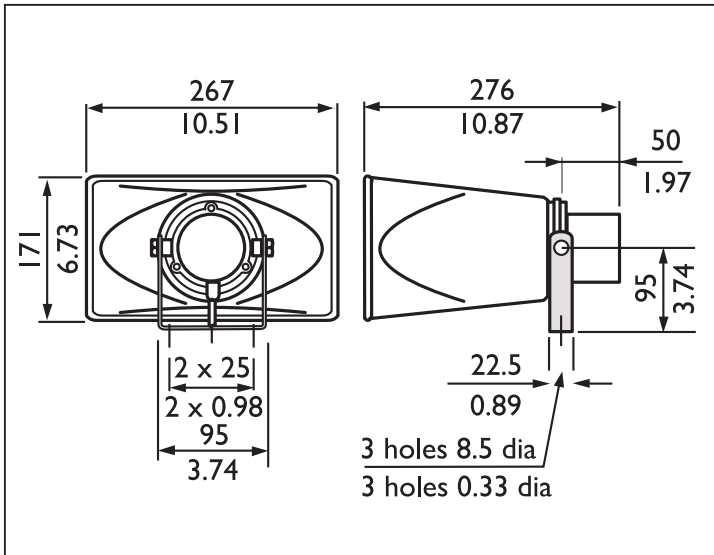

Dimensions (in mm and inches)

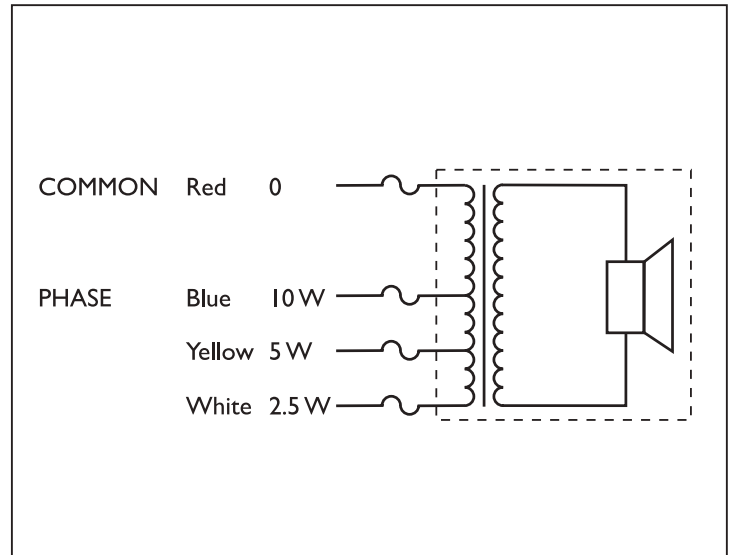

Circuit diagram

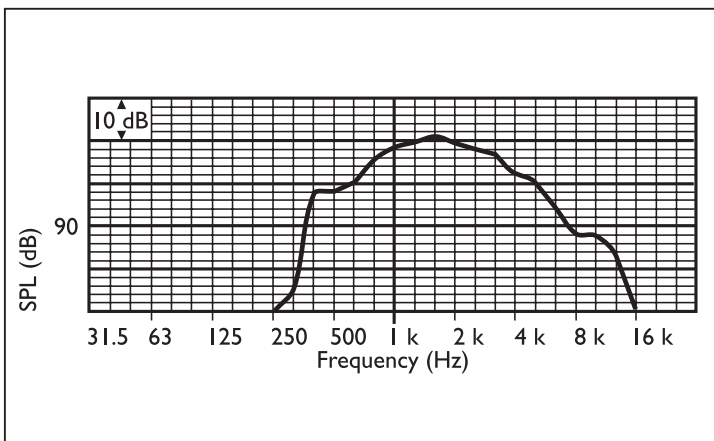

Frequency response

## Technical performance data acc. to IEC 268-5

Max. power  
 Rated power (PHC)  
 Sound pressure level at rated power/1 W  
 (at 1 kHz, 1 m)  
 Effective frequency range (-10 dB)  
 Opening angle (at 1 kHz/4 kHz, -6dB)  
 Rated voltage  
 Rated impedance  
 Ambient temperature range  
 Water- and dust protected  
 Safety  
 Connection  
 Dimensions  
     aperture dia.  
     overall length  
 Colour  
 Weight

## LBC 3492/12

30 W  
 20 W (20 - 10 - 5 W)  
 123 dB/110 dB (SPL)  
 380 Hz to 5.5 kHz  
 80°/35°  
 100 V  
 500 Ω  
 -25 to +55 °C  
 acc. to IEC 60529 IP 65  
 acc. to EN 60065  
 4-wire cable, 2 m long  
 354 mm (13.94 in)  
 332 mm (13.07 in)  
 Light grey (RAL 7035)  
 2.65 kg (5.83 lb)

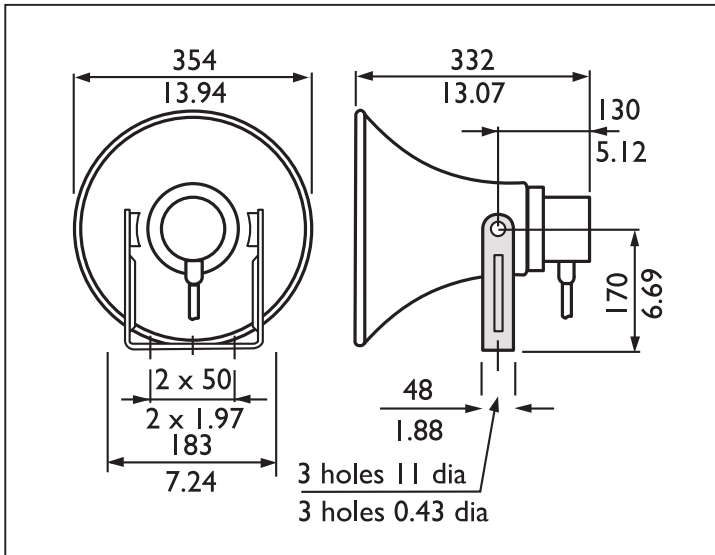

Dimensions (in mm and inches)

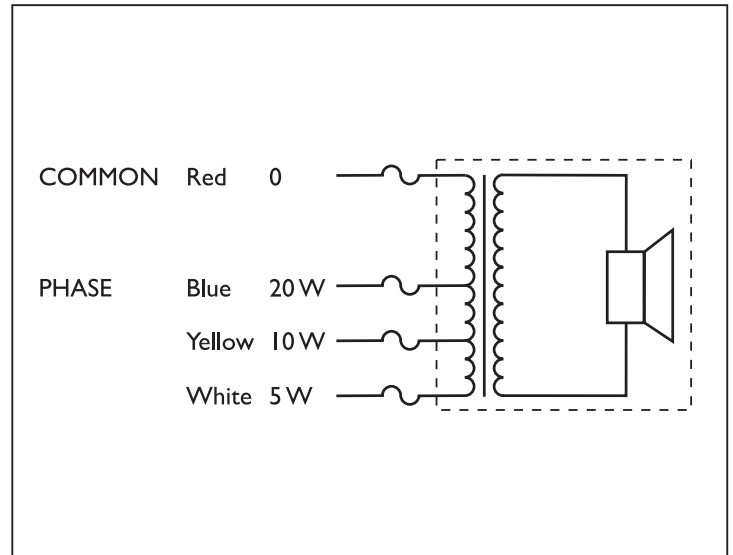

Circuit diagram

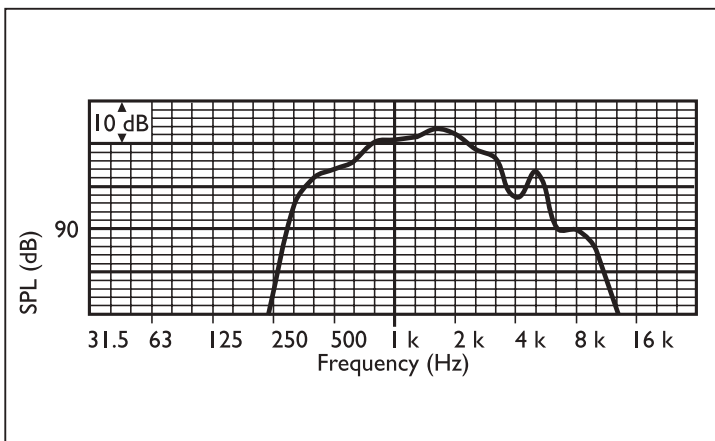

Frequency response

## Technical performance data acc. to IEC 268-5

Max. power

Rated power (PHC)

Sound pressure level at rated power/1 W  
(at 1 kHz, 1 m)

Effective frequency range (-10 dB)

Opening angle (at 1 kHz/4 kHz, -6dB)

Rated voltage

Rated impedance

Ambient temperature range

Water- and dust protected

Safety

Connection

Dimensions

aperture dia.

overall length

Colour

Weight

## LBC 3493/12

45 W

30 W (30 - 15 - 7.5 W)

126 dB/111 dB (SPL)

380 Hz to 5 kHz

70°/40°

100 V

333 Ω

-25 to +55 °C

acc. to IEC 60529 IP 65

acc. to EN 60065

4-wire cable, 2 m long

400 mm (15.75 in)

353 mm (13.90 in)

Light grey (RAL 7035)

3 kg (6.6 lbs)

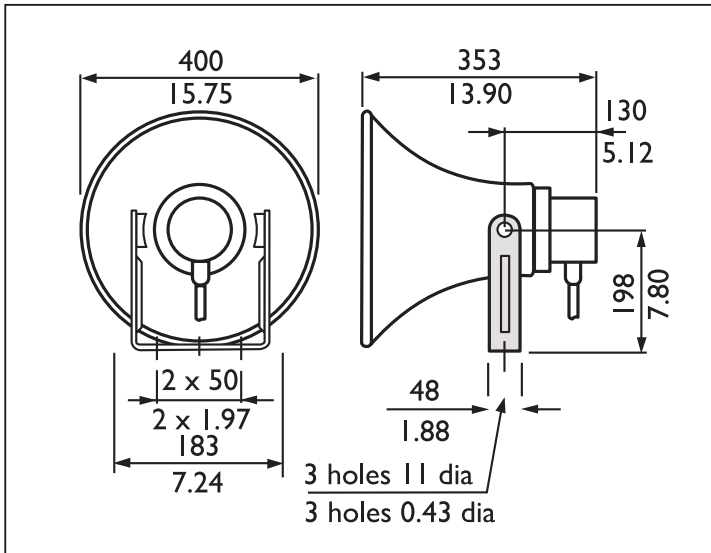

Dimensions (in mm and inches)

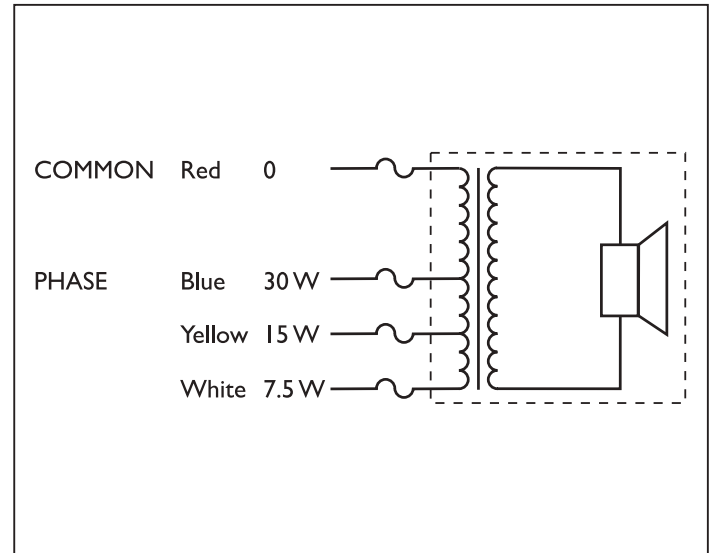

Circuit diagram

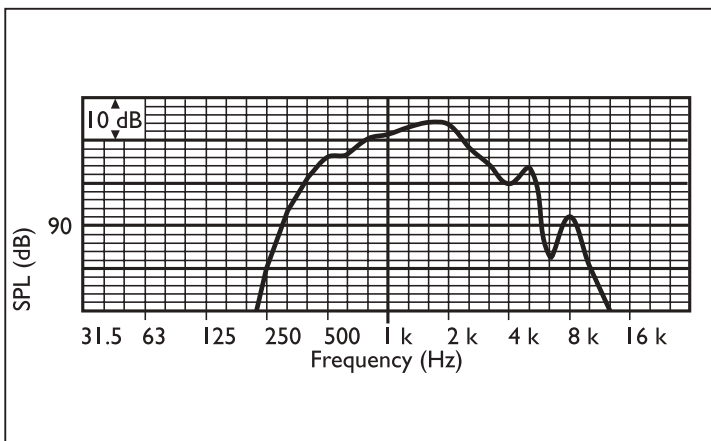

Frequency response

### LBC 3481/12

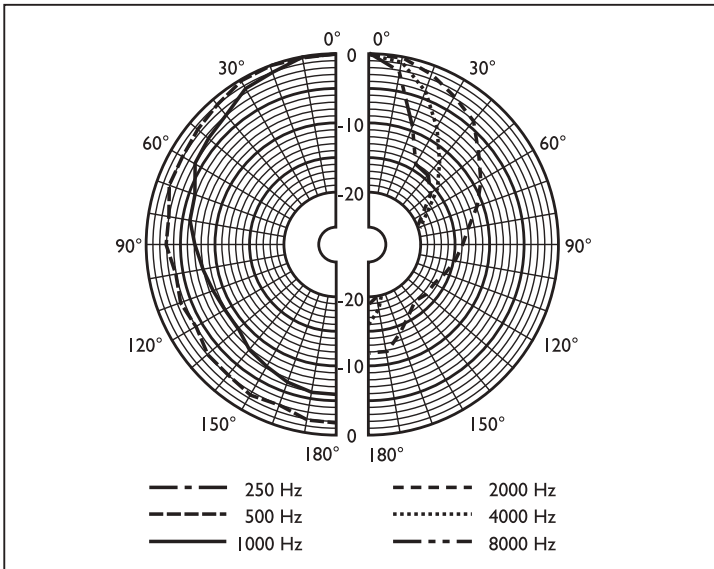

Polar diagram (measured with pink noise)

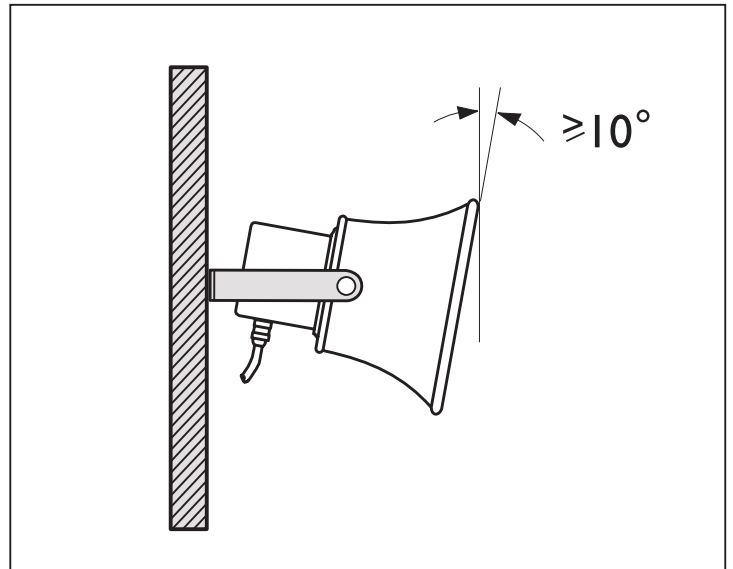

### LBC 3491/12

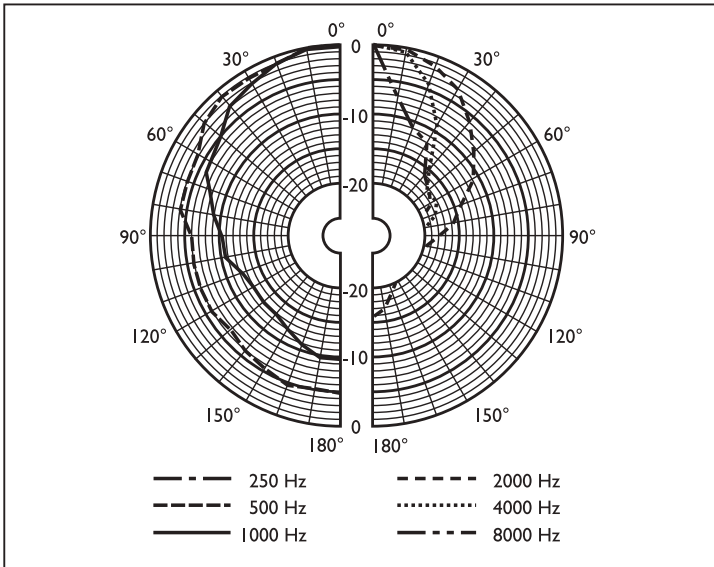

Polar diagram vertical (measured with pink noise)

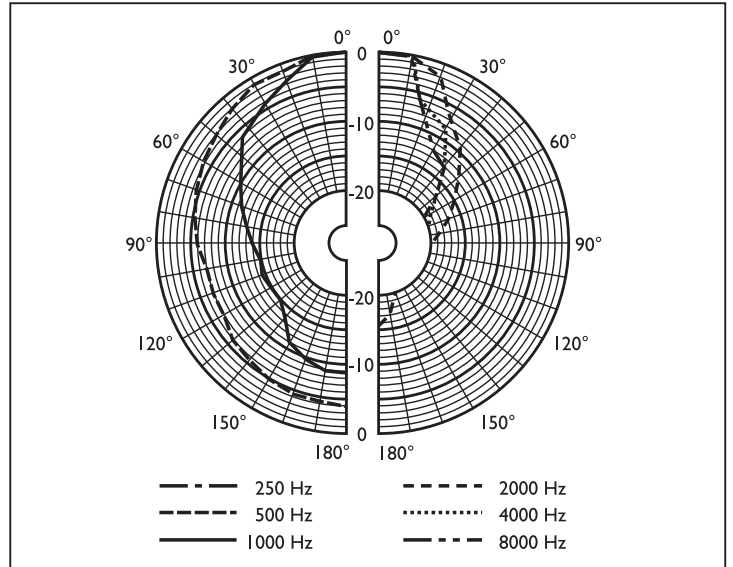

Polar diagram horizontal (measured with pink noise)

### LBC 3492/12

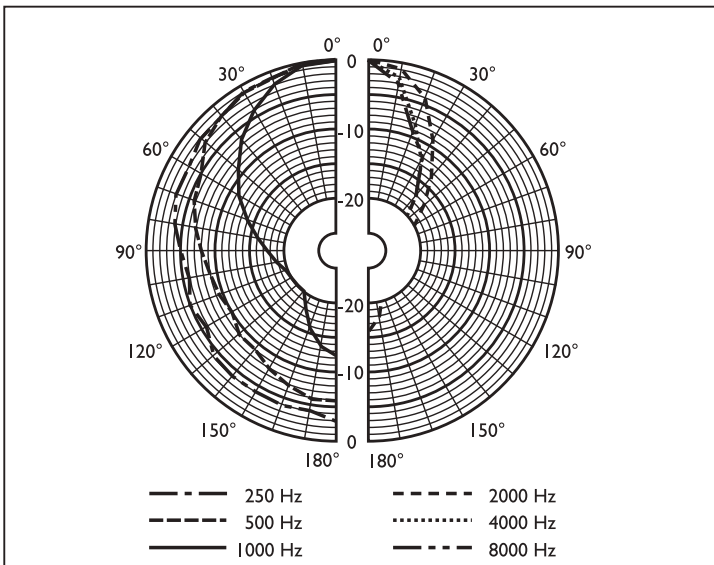

Polar diagram (measured with pink noise)

### LBC 3493/12

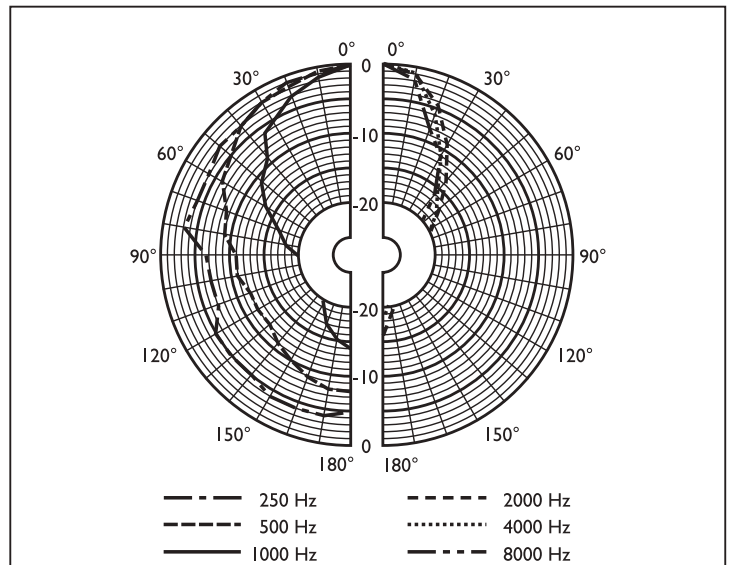

Polar diagram (measured with pink noise)