

# Control 1 Pro

Product User's Guide  
Two-Way, Professional Compact Loudspeaker



## Control 1 Pro

### Key Features

- 150 Watts Continuous Power Handling
- Professional Drivers and Crossover Network
- Included Mounting Bracket
- Transparent and Faithful Sonic Performance
- Magnetically Shielded Enclosure
- SonicGuard™ Overload Protection

Your Control 1 Pro is a compact, high-performance professional loudspeaker system that features monitor-grade low and high frequency drivers coupled with a professional crossover network. The rugged and durable molded enclosure is magnetically shielded making the Control 1 Pro ideal for use with video and computer monitors or other magnetically sensitive equipment. Moreover, the Control 1 Pro's compact design is ideal for audio-visual applications, computer workstations, recording and broadcast studios, mobile audio-video control rooms and foreground and background music.

## Bracket Assembly and Mounting Guide

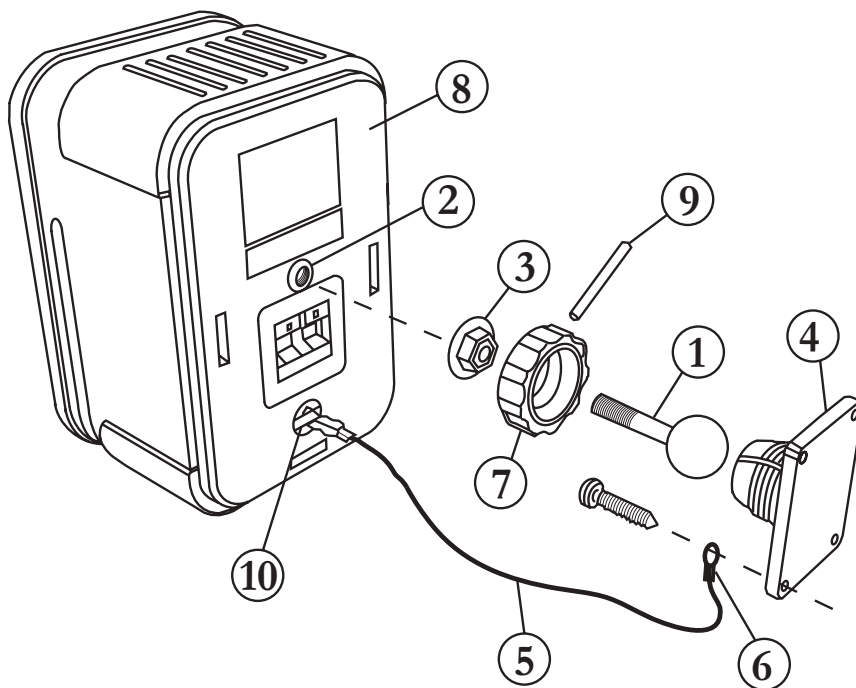

- A) Screw the metal rod/ball assembly (1) into the threaded insert (2) on the back of the cabinet (8) until it is seated against the bottom of the insert.
- B) Next, tighten the "knurled" nut (3) with a small wrench until it is seated against the back of the cabinet. Tighten the nut until it has "locked" the rod/ball assembly (1) to the cabinet. Note: the nut may leave marks on the back of the cabinet where the attachment is made however, the flange of the nut will cover these marks.

- C) Mount the wall bracket plate (4) onto a flat sturdy surface using the appropriate mounting hardware for the surface. A safety cable (5) (not included) may be attached to the wall bracket via its eyelet (6) at one of the two lower screw mounting points or to a secondary point off the mounting plate.
- D) Next, slip the large molded nut (7) over the ball on the metal rod/ball assembly (1).
- E) Holding the cabinet (8) with both hands, insert the ball on the metal rod/ball assembly (1) into the cup of the wall plate (4).
- F) Orient the speaker into the desired position and hand tighten the molded nut (7). Once the orientation is finalized, use the metal bar (9) in one of the holes on the molded nut (7) to securely tighten.
- G) Finally, clip the safety cable to the cabinet's safety bar (10) on the back of the cabinet.

## Rotating the Logo

The Control 1 Pro's logo can be oriented for display at 90° increments. To rotate the logo, first gently pry the grille and gasket from the cabinet. Next, push-in the logo's fastener (found on the underside of the grille) and rotate the logo to the desired position.

## Troubleshooting

If there is no sound from your speakers:

- Make sure your power amplifier is on and the gain is set above its minimum setting.
- Make sure there is a signal to your amplifier from your mixer.
- Ensure all wires are connected and that none are cut or frayed.
- If more than one pair of speakers is being used, check the minimum impedance requirements of your amplifier (overloading your amplifier can result in damage to your amp).

If there is no sound from one of your speakers:

- Check the balance control on your mixer.
- Check the channel output gains of your amplifier.
- Ensure all wires are connected and that none are cut or frayed.

If there is no (or weak) bass output or a poor stereo image:

- Make sure the polarities (+ and -) of the speakers inputs are properly connected.

## Specifications

### System:

Frequency Range (-10 dB):	80Hz - 20kHz
Frequency Response (+/- 3 dB):	100Hz - 18kHz
Power Capacity <sup>1</sup> :	150 W
Sensitivity <sup>2</sup> :	87dB SPL, 1 W 1m (3.3 ft)
Maximum SPL <sup>3</sup> :	108dB continuous, 114dB peak
Directivity Factor (Q) <sup>2</sup> :	6.0
Directivity Index (DI):	7.8dB
Nominal Impedance:	4 ohms
Crossover Frequency:	4.2kHz
Overload Protection:	Full-range SonicGuard™ power limiting to protect network and transducers

### Transducers:

LF Driver:	135mm (5.25 in) low frequency loudspeaker
HF Driver:	19mm (.75 in) polycarbonate dome tweeter

### Enclosure:

Enclosure Material:	Polypropylene Structural Foam
Finish:	Black or White
Dimensions:	235mm x 159mm x 143mm (9.25 in x 6.25 in x 5.6 in)
Net Weight (each):	1.8 kg (4 lbs)
Shipping Weight (pair):	4.6 kg (10 lbs)
Included Accessories:	Mounting Bracket Assembly

<sup>1</sup> IEC Standard, full bandwidth pink noise with 6 dB crest factor; 2 hour duration

<sup>2</sup> Average 1 kHz to 10 kHz

<sup>3</sup> Calculated based on power rating exclusive of power compression

JBL continually engages in research related to product improvement. Changes introduced into existing products without notice are an expression of that philosophy.