



# PRX625

## Self Powered Dual 15", Two-Way, Bass-Reflex

### Professional Series

### Features:

- ▶ Maximum SPL Output 139 dB peak
- ▶ 2 x 380 mm (15 in) Differential Drive® dual voice-coil and magnetic gap, neodymium woofers
- ▶ 37.5 mm (1.5 in) annular polymer diaphragm, neodymium compression driver
- ▶ 1500 Watt (3 x 500 watt) Class-D, Crown® digital amplifier
- ▶ DSP input section with dbx® Type IV™ limiter circuit, crossover, dynamic limiting, component optimization, selectable system EQ
- ▶ Professional XLR line and ¼ in Mic/Instrument inputs, with loop-through
- ▶ Obsidian DuraFlex™ coated plywood construction
- ▶ Large glass-filled nylon handlebar with a fine tuned ergonomic rubber grip for maximum comfort
- ▶ 8 M10 Suspension points and 1 pullback point

### Application:

If a simple set-up is required and full bandwidth output at high levels is a must, then the PRX625 is most likely the optimum solution. With the same footprint as the PRX515M, the dual 15 in woofer design creates enough low frequency content to serve most live music or music playback situations. When coupled with a PRX subwoofer (or multiple subwoofers) the system becomes a high volume sound reinforcement solution, perfect for regional tour companies and AV rental companies looking for a scalable, easy to employ audio solution. We recommend using the PRX618S-XLF in conjunction with the PRX625 as the extended low frequency capabilities of the subwoofer complement the frequency response of the PRX625. For live music, recorded music playback and speech, the user has the option of tailoring the EQ, 'flat' for speech intelligibility and 'boost' for enhanced bass and crisp highs in recorded music playback. A microphone can be directly connected to the speaker input for quick on-the-fly PA applications.

The PRX625 is a self-powered, lightweight two-way loudspeaker system capable of delivering a very high level of performance over a broad bandwidth. The PRX625 is comprised of two 380 mm (15 in) 265F-1 Differential Drive® woofers, a 2408H-1, 37.5 mm (1.5 in) annular polymer diaphragm, neodymium compression driver mounted to a 90° by 50° horn, all driven by a multi-channel Crown® Class-D power amplifier. A proprietary DSP chip is at the core of a fully featured input section, providing user selectable system EQ, protection, input sensitivity selection, cross-over functionality, dynamic limiting and discrete component optimization.

The amplifier input panel offers XLR or ¼ in jack compatibility and a sensitivity switch provides extra flexibility, making it possible to connect literally any sound source without using a mixer. Signal present and overload lights indicate the system status and assist in setting the optimum level, via the level control knob.

All PRX600 cabinets are built from a combination of 25 mm (on the top and bottom for added rigidity) and 18 mm, strong, lightweight poplar plywood made structurally sound with tongue and groove joints. All PRX600 Series cabinets are protected by JBL's tour proven DuraFlex™ finish. Grilles are made from dent-resistant 16 gauge steel and handles are made from lightweight, glass-filled nylon for added strength and durability. All M10 suspension points are constructed from 14 gauge steel and have been tested with a yield-strength of 1000 lbs. each.



### Specifications:

System	
System Type:	Self powered dual 15", two-way, bass-reflex
Maximum SPL Output:	139 dB peak
Frequency Range (-10 dB):	Flat 40 Hz-19.5 kHz Boost 39 Hz-19.5 kHz
Frequency Response (±3 dB):	Flat 55 Hz-17.5 kHz Boost 50 Hz-18 kHz
Input Connectors:	Balanced XLR / ¼" combo jack with XLR loop through
Input Impedance:	20K ohms (balanced), 10K ohms (unbalanced)
Signal indicators:	Limit: Red LED indicates limiter active condition Signal: Green LED indicates signal present
EQ:	Presets for use in Main and Boost position
Dynamic Control (Input):	dbx Type IV™ limiter circuit
Crossover Modes:	DSP controlled. LF: 48 dB/Oct filter slope High & Low Pass; HF: 36 dB/Oct High Pass
Crossover Frequency:	1.8 kHz
Amplifier	
Design:	Crown® Class D
Power Rating:	1500 W (3 x 500)
Speaker	
LF Driver:	2 x JBL 265F-1 380 mm (15") Differential Drive® dual voice-coil and magnetic gap, neodymium woofer
HF Driver:	1 x JBL 280H-1 37.5 mm (1.5") annular polymer diaphragm, neodymium compression driver
Coverage Pattern:	90° x 50° nominal
Directivity Index (DI):	10.2 dB
Directivity Factor (Q):	10.1
Enclosure:	Trapezoidal, 18 mm, plywood
Suspension/ Mounting:	8 x M10 Suspension Points and 1 x M10 Pull-Back Point
Transport:	Integrated handle with backing cup
Finish:	Obsidian DuraFlex™ finish
Grille:	Powder coated, Obsidian, 16 gauge perforated steel with acoustically transparent black cloth backing.
Input Connectors:	Balanced XLR / ¼" combo jack with XLR loop through
Dimensions (H x W x D):	1,053 mm x 430 mm x 413 mm (41.47" x 16.9" x 16.27")
Net Weight:	27.2 kg (60 lb)
Gross Weight:	29.2 kg (64.5 lb)

Maximum Peak output measured with IEC pink noise at 1 meter in front of speaker baffle under free space conditions. Measurement instrument set to peak hold. Speaker muted and released at full power, recording maximum peak level.

JBL continually engages in research related to product improvement. Some materials, production methods and design refinements are introduced into existing products without notice as a routine expression of that philosophy. For this reason, any current JBL product may differ in some respect from its published description, but will always equal or exceed the original design specifications unless otherwise stated.

# ▶ PRX625 Dual 15" Self Powered Two-Way, Bass-Reflex

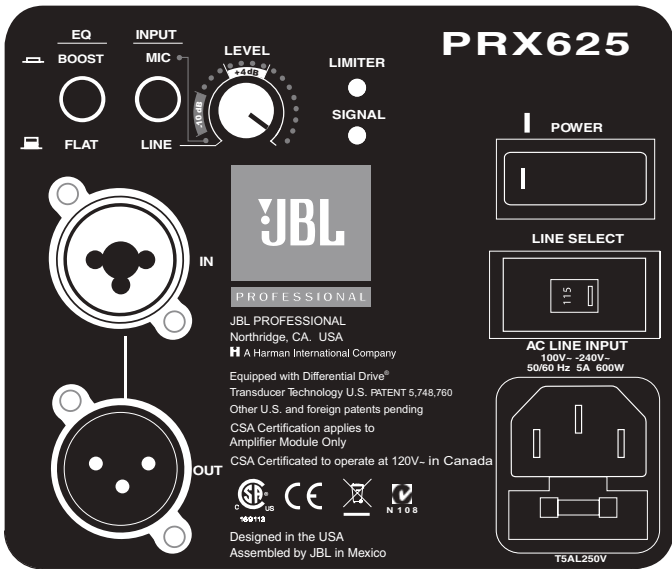

PRX625 Input Panel

## Frequency Response

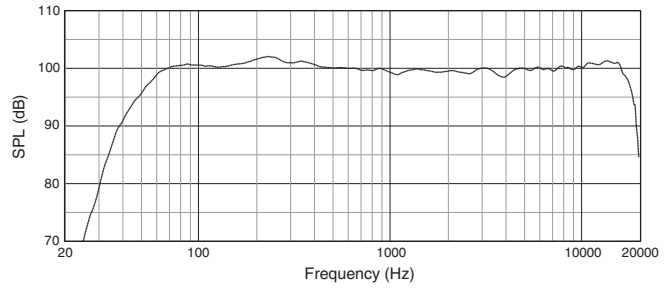

## Block Diagram

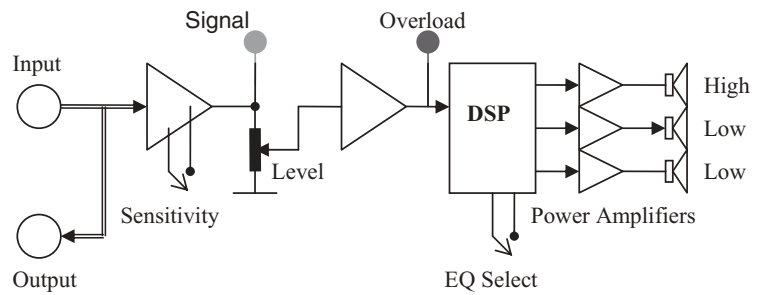

## Dimensions in (mm) inches

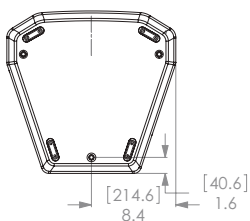
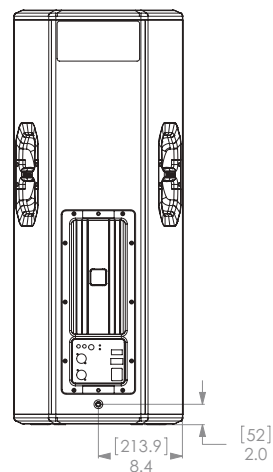
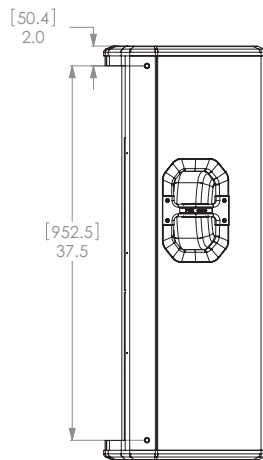
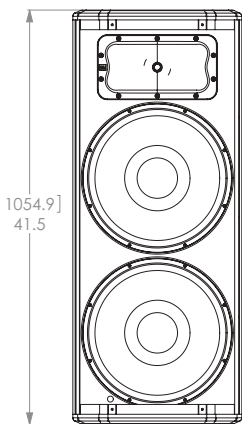
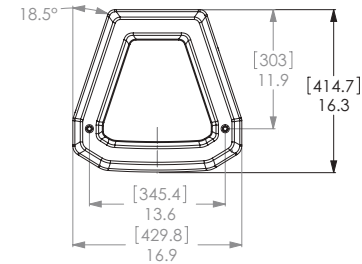

JBL Professional  
8500 Balboa Boulevard, P.O. Box 2200  
Northridge, California 91329 U.S.A.

© Copyright 2010 JBL Professional  
[www.jblpro.com](http://www.jblpro.com)

SS PRX625  
CRP  
05/10