

# Technical Manual



# JBL VT4881

## SPECIFICATIONS

### ACOUSTIC & ELECTRICAL SPECIFICATIONS:

- Frequency Response: 22 Hz-125 Hz ( $\pm 3$  dB)
- Sensitivity 90dB, 2.83 Vrms. @ 1m (25 Hz - 85 Hz)
- Max Peak Output: 126 dB @ 1M  
(Frequency/Bandpass Dependent)
- Recommended Signal Processing: Digital System Controller: dbx 480, BSS 366, XTA 226 Supported
- Crossover Frequency: 125 Hz

### SYSTEMS COMPONENTS:

- Cabinet: Enclosure Assembly C4881
- Grille: (350810-001)
- Low Frequency Transducer: (1) 2256G, 380 mm (15 in.)  
76 mm (3 in.) Dual Coil Differential Drive

- Nominal Impedance: 8 Ohms (Each Coil)
- Input Power Rating: 600W Continuous Pink Noise
- Bandpass Sensitivity: 90 dB, \*SPL (System Bandpass)
- DC Resistance: 2 x 6.0 Ohms

### AURAL SWEEP TEST SPECIFICATIONS:

- A. System Aural Sweep Test: 10.0V Input, 10 Hz to 100 Hz
- B. LF. Aural Sweep Test: 10.0V Input, 10 Hz to 100 Hz

### PHYSICAL SPECIFICATIONS:

- Enclosure Dimensions: 566 mm x 787 mm x 655 mm D  
(22 x 31x 25.8 in. D)
- Shipping Weight: VT4881 114 lbs. (58.1 kg)  
VT4881-ACC 35.5 lbs. (16.1 kg)

### WARRANTY INFORMATION:

- Refer to Warranty Statement packed with each product.

### SYSTEMS COMPONENTS (Cont.):

## PACKAGE

Warranty 59660  
Specification Sheet 350621-001

Filler (2) 351866-001  
Microfoam (8) 49790P

Carton 351865-001

Dolly Assembly 350434-002 and 350434-003

Soft Cover 350530-001

Carton 350531-001

Filler, Bottom (2) 350532-001

Filler, Top (2) 351391-001

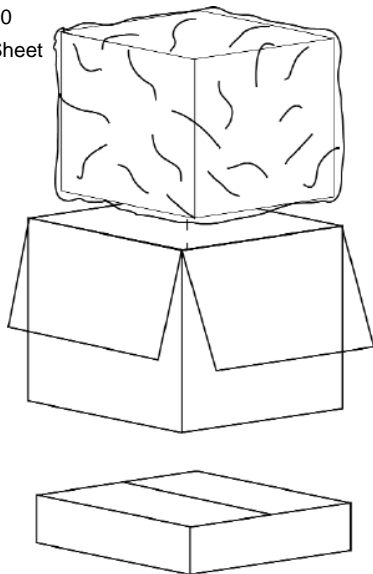

JBL VT4887-SF	JBL VT4887-AF
Carton 350712-001	Carton 350487-001
Filler (2) 350713-001	Filler (2) 350466-001
Owner's Manual 350485-001	Owner's Manual 35048-001

## WIRING

Driver, Low Freq. (1)  
2256G  
(339548-001X)  
Cone Repl  
C4R2256

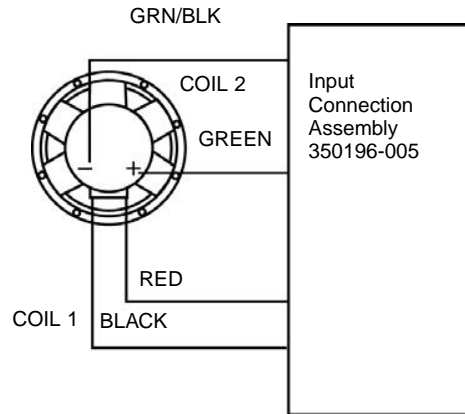

Connector Assembly  
350991-001

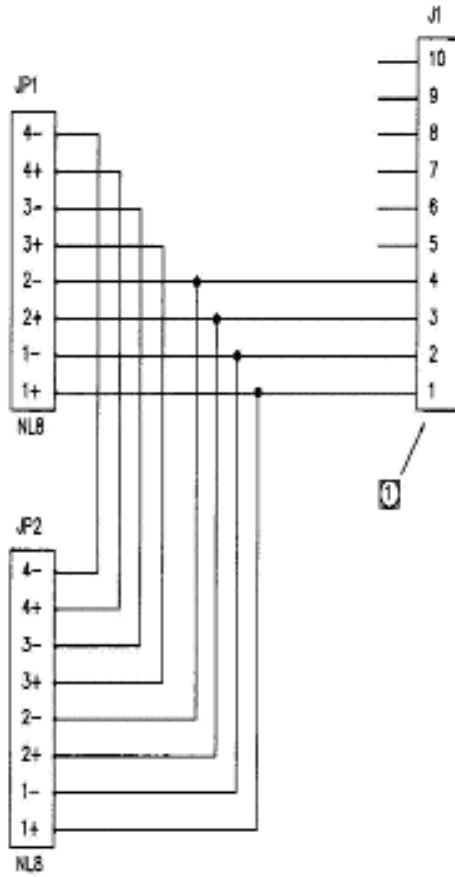

Wire Harness  
350992-001

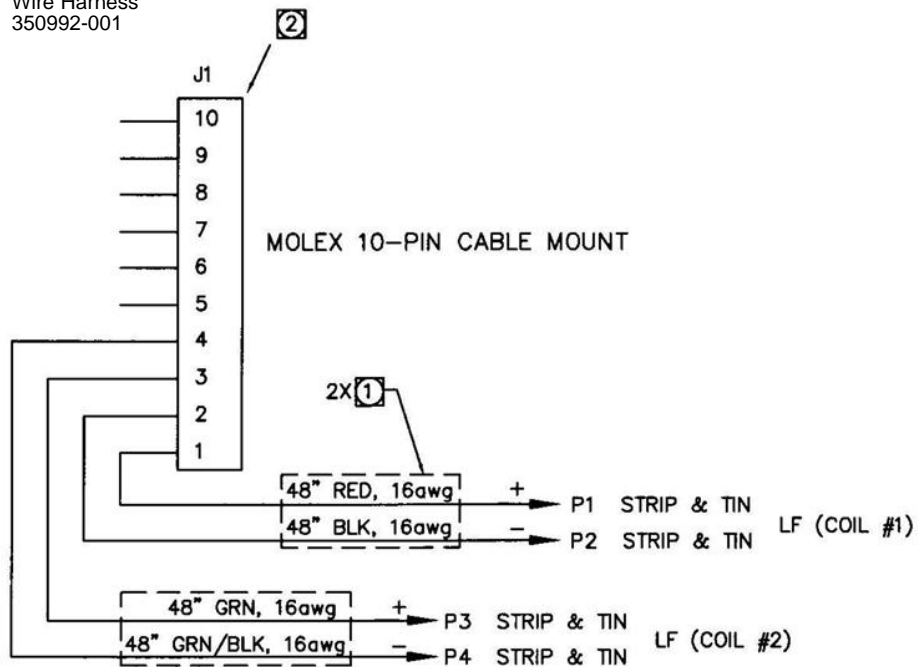

# JBL VT4881

## COMPONENT EXPLODED VIEW

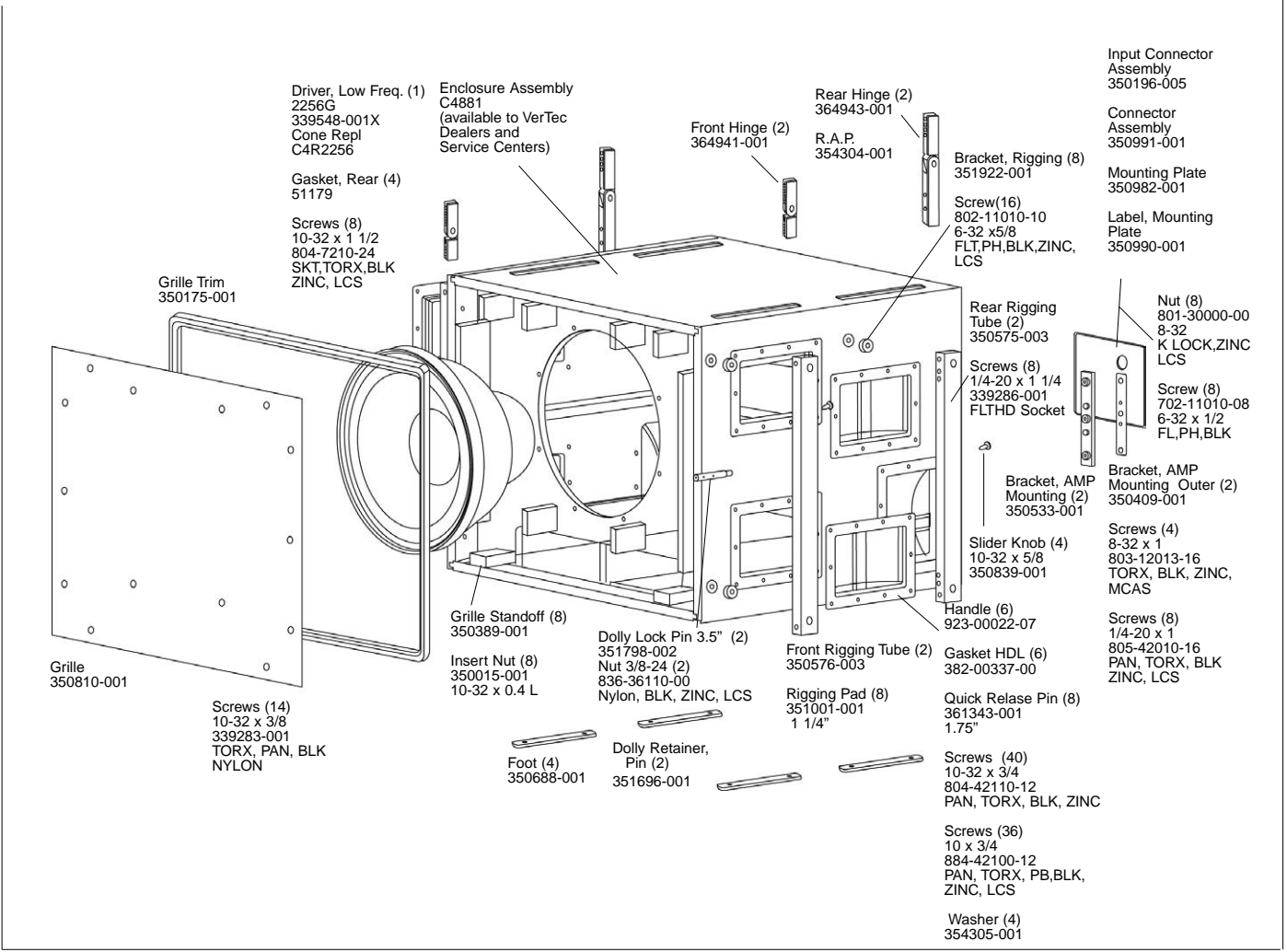

JBL VT4881

# JBL VT4881-ACC

## DOLLY ASSEMBLY 350434-002

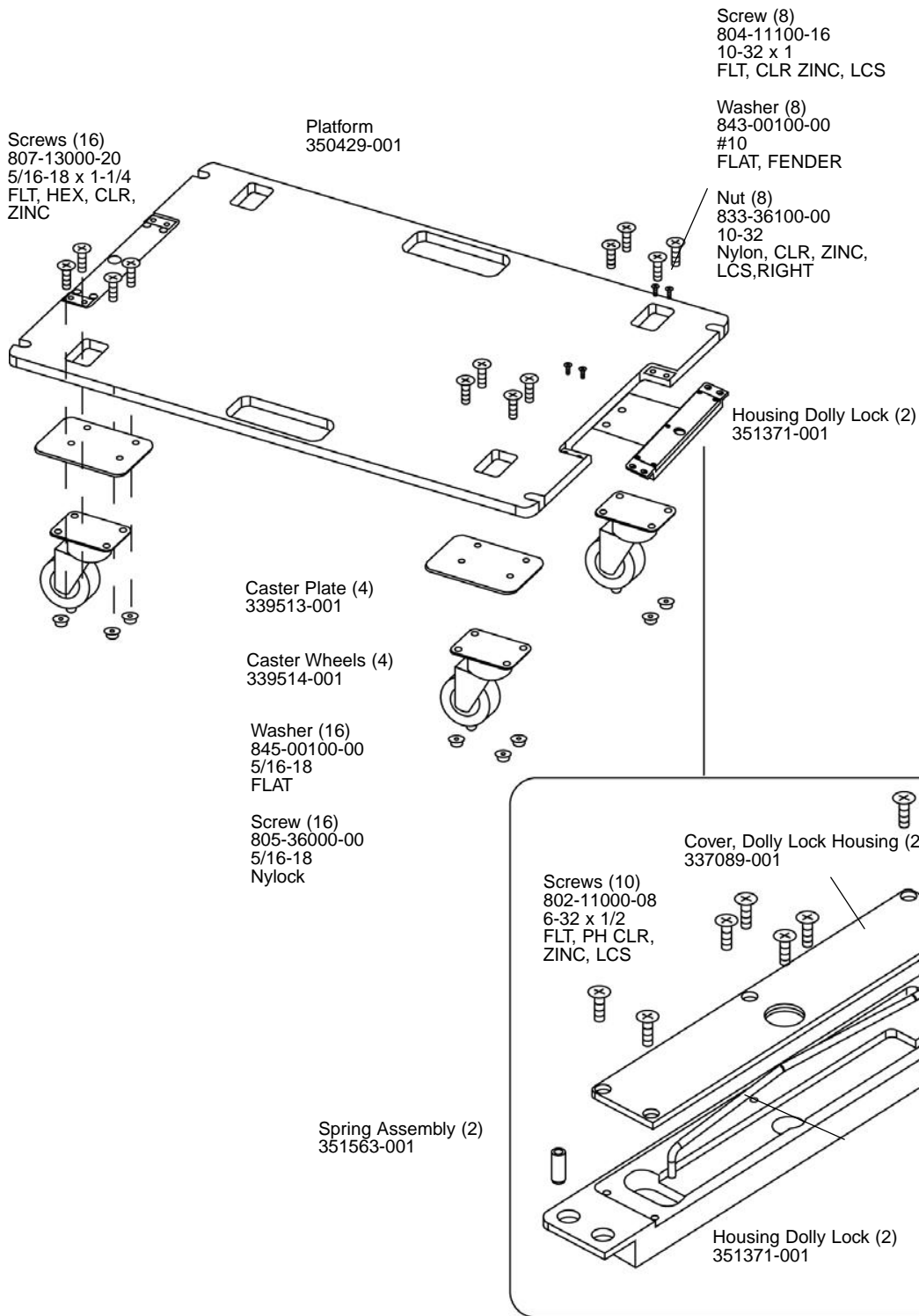

JBL VT4881-ACC

# JBL VT4881-ACC

## DOLLY ASSEMBLY 350434-003

Screw (16)  
807-13000-20  
5/16-18 x 1-1/4  
FLT HEX, CLR,  
ZINC,LC

Dolly Platform  
351895-003  
(w/c sink holes)

Screw (16)  
807-13000-20  
5/16-18 x 1-1/4  
FLT HEX, CLR,  
ZINC,LC

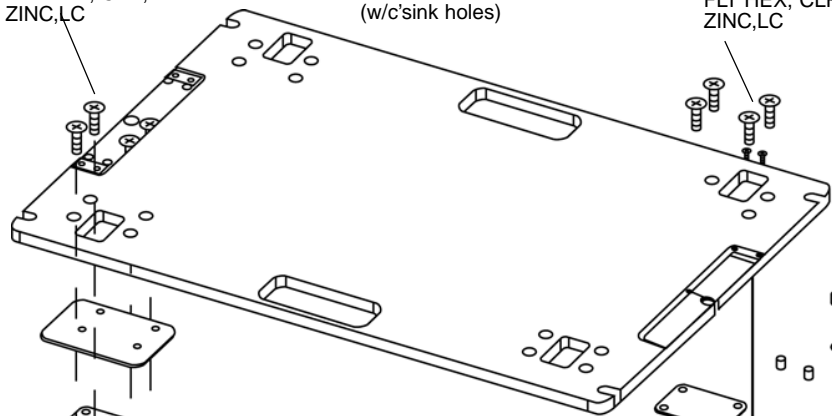

T-Nut (2)  
21749  
8-32 x 1/4  
CP

Insert (10)  
8161207-001  
8-32 x 4MM  
HXS,KNIFE32608C10ZC

Caster Plate (4)  
339513-001

Caster Wheels (4)  
339514-001

Nut (16)  
352018-001  
Nylock Special

Screw (12)  
803-11000-08  
8-32 x 1/2  
FLT,PH,CLR,  
ZINC,UNC

Cover,Dolly Housing (2)  
351893-001

Spring Assembly (2)  
351899-001

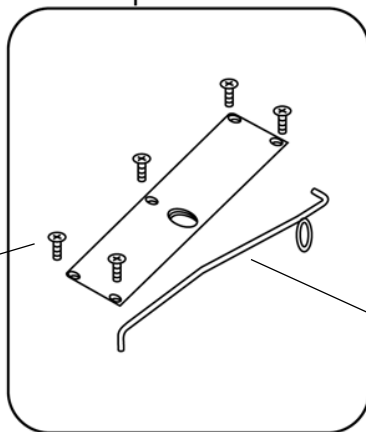

# JBL VT4887-SF

## ARRAY FRAME ASSEMBLY

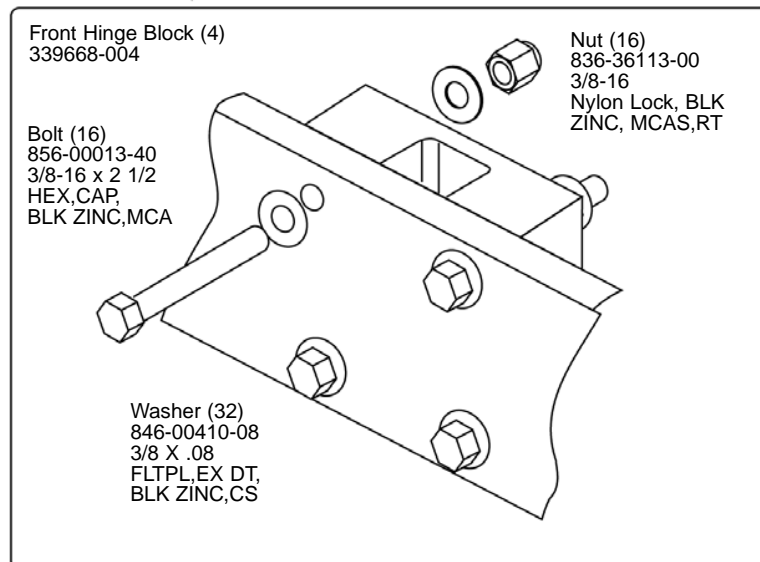
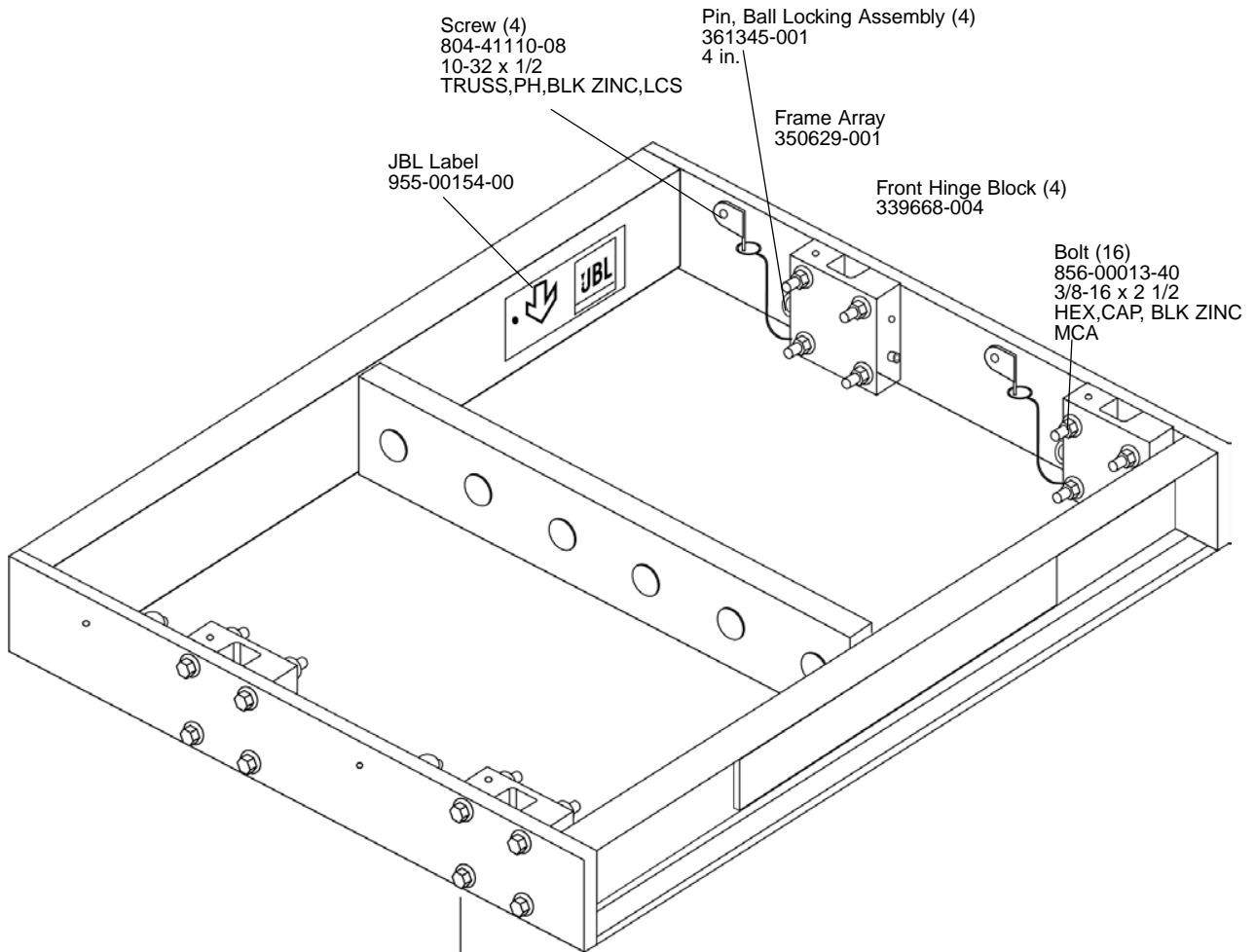

JBL VT4887-SF

# JBL VT4887-AF

## ARRAY FRAME ASSEMBLY

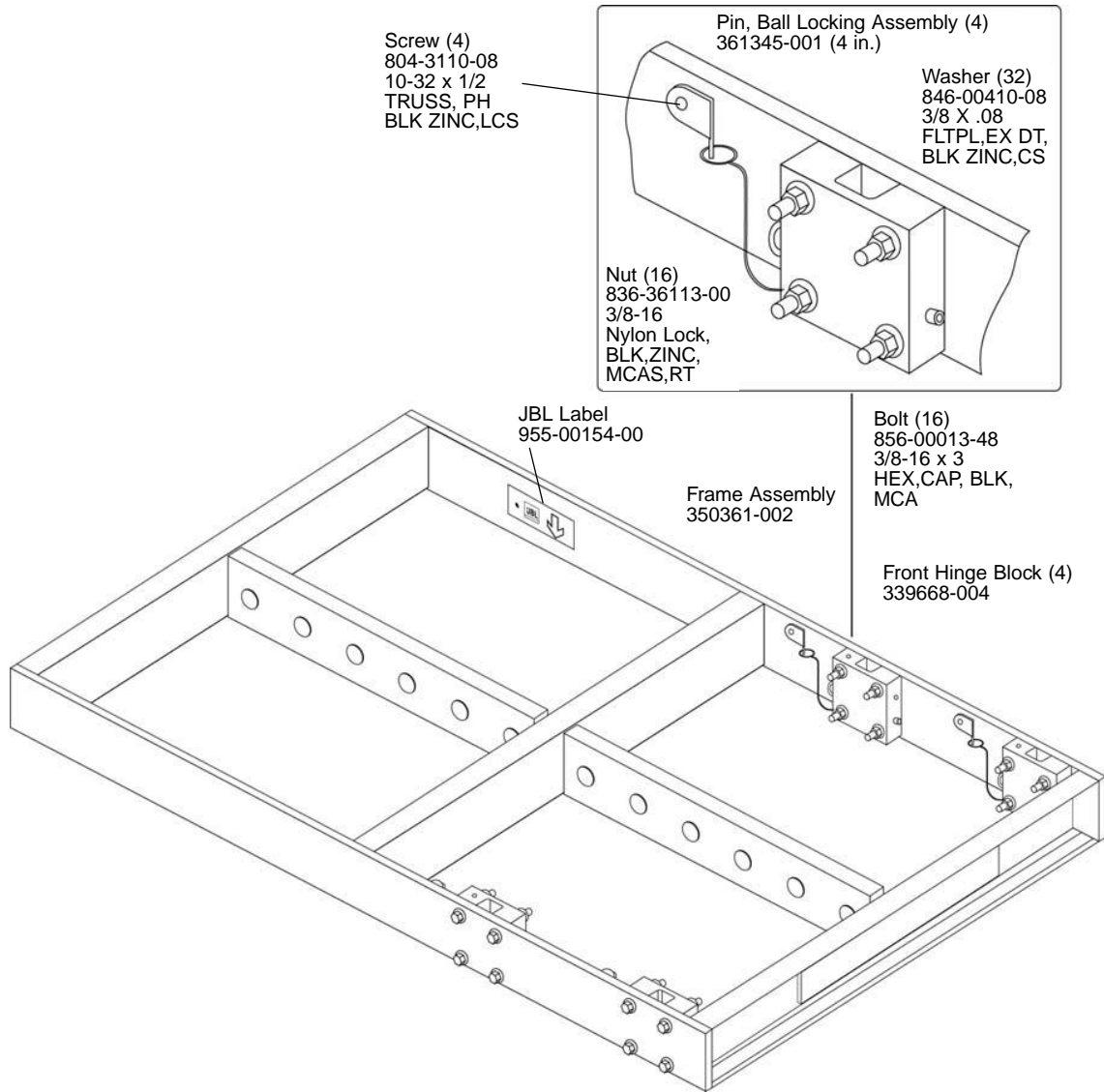

JBL VT4887-AF