

Technical Manual



JBL VT4887

SPECIFICATIONS

ACOUSTIC & ELECTRICAL SPECIFICATIONS:

- Frequency Response: 80 Hz- 20 kHz (± 3 dB)
- Horiz Coverage Angle: 100°, 500 Hz - 16 kHz (-6dB)
- Vert Coverage Angle: Varies with size and configuration(-6dB)
- Max Peak Output: 131 dB to 141 dB @ 1M
(Frequency/Bandpass Dependent)
- Recommended Signal: Digital System Processing: (Factory Settings) dbx 480, BSS 366, XTA 226
- Crossover Frequency: 415 Hz LF to MF/HF; 2.1 kHz MF to HF (Passive Crossover Network)

SYSTEMS COMPONENTS:

- Cabinet: Enclosure Panels: Top/Bottom (350764-001), Side, 2x (350763-001), Rear (350762-001)
- Grille: Left (350768-001), Right (350768-002)
- Low Frequency Transducer: (2) 2168J, 208 mm (8") dia., 76 mm (3") Dual Coil Differential Drive
Nominal Impedance: 16 ohms (Per Driver)
Input Power Rating: 1000W (4000W peak) 2 hrs.
700W (2800W peak) 100 hrs.
Bandpass Sensitivity: 97 dB,1W @ 1m (3.3 ft.)
DC Resistance: 5.2 Ohms
- Mid Frequency Transducer: (4) 2104H, 101 mm (4") dia. 25.4 mm (1") Coil
Nominal Impedance: 8 Ohms (Per Driver)
Input Power Rating: 225W (900W peak) 100 hrs.
Bandpass Sensitivity: 101 dB,1W @ 1m (3.3 ft.)
DC Resistance: 4.2 Ohms

SYSTEMS COMPONENTS (Cont):

- High Frequency Transducer: (2) 2407H, Neodymium Ultra Light Ring Radiator
Nominal Impedance: 8 Ohms (Per Driver)
Input Power Rating: 225W (900W peak) 100 hrs.
Bandpass Sensitivity: 101 dB,1W @ 1m (3.3 ft.)
DC Resistance: 4.3 Ohms

AURAL SWEEP TEST SPECIFICATIONS:

- A. System Aural Sweep Test (thru processor/measured at the amp output): 6V, 80 Hz to 20 kHz
- B. LF Woofer Sweep Test (per ets): 3V, 80 Hz to 400 Hz
- C. MF Woofer Sweep Test (per ets): 2V, 500 Hz to 5 kHz
- D. HF Driver Sweep Test (per ets): 1.2V, 800 Hz to 20 kHz

PHYSICAL SPECIFICATIONS:

- Enclosure Dimensions: 279 mm x 787 mm x 417 mm D (11 x 31x 16.4 in. D)
- Shipping Weight: 85 lbs. (39 kg)
VT4887
VT4887-ACC 25 lbs. (11.4kg)

WARRANTY INFORMATION:

- Refer to Warranty Statement packed with each product.

PACKAGE

- Filler (2) 351864-001
- Microfoam (8) 49790P
- Carton 351863-001
- Fiberglass (18) 22389P
- Chip FBRBRD 300982-001

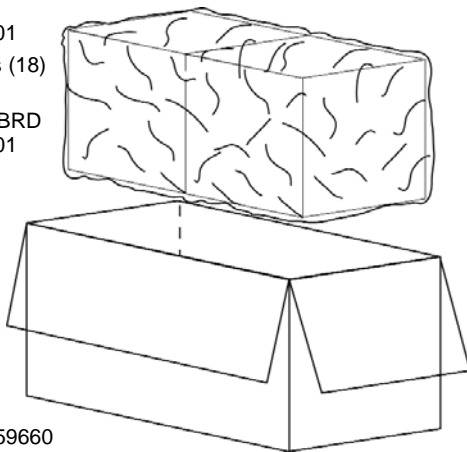

- Warranty 59660
- Specification Sheet 350619-001

- Dolly Assembly (VT4887) 350401-003
- Carton 350528-001
- Filler, Top (2) 351400-001
- Filler, Bottom (2) 350529-001
- Soft Cover 350527-001

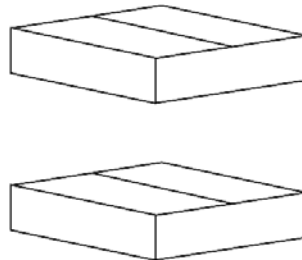

- JBL VT4887-SF
Carton 350712-001
Filler (2) 350713-001
Owner's Manual 350485-001

- JBL VT4887-AF
Carton 350487-001
Filler (2) 350486-001
Owner's Manual 350485-001

JBL VT4887 REV AAA

JBL VT4887

WIRING DIAGRAM

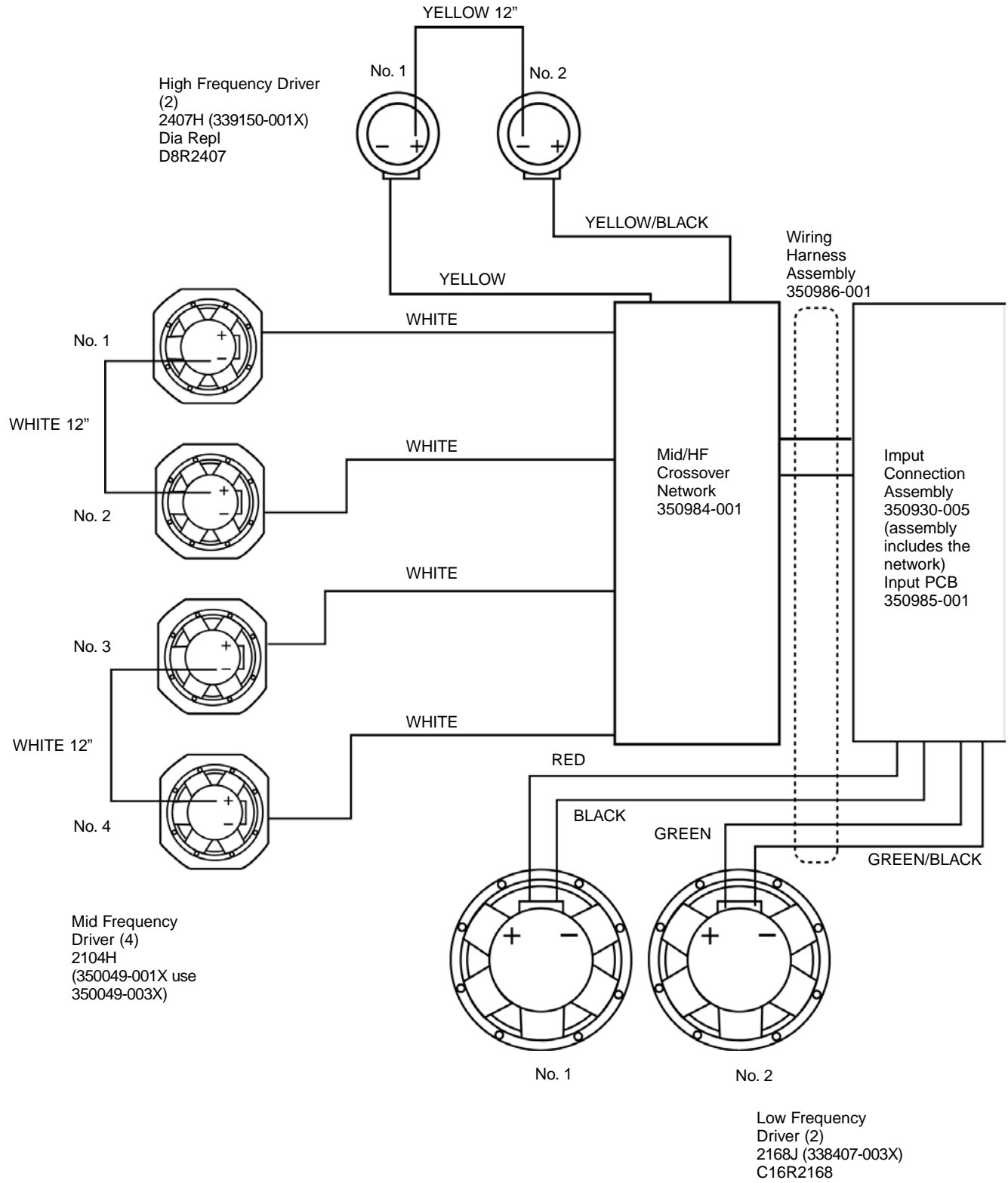

SCHEMATIC DIAGRAMS

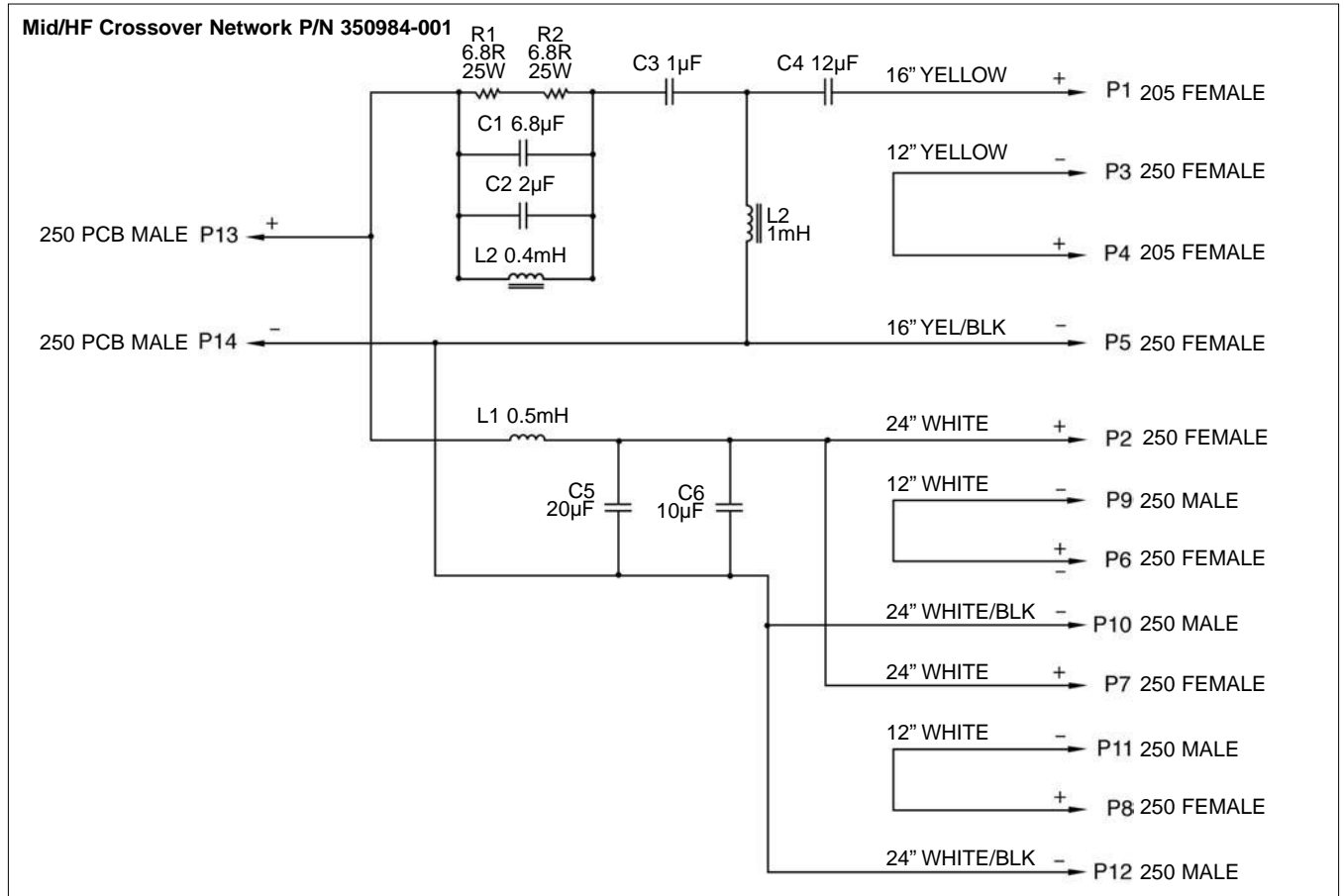

Input Connection Assembly P/N 350930-005

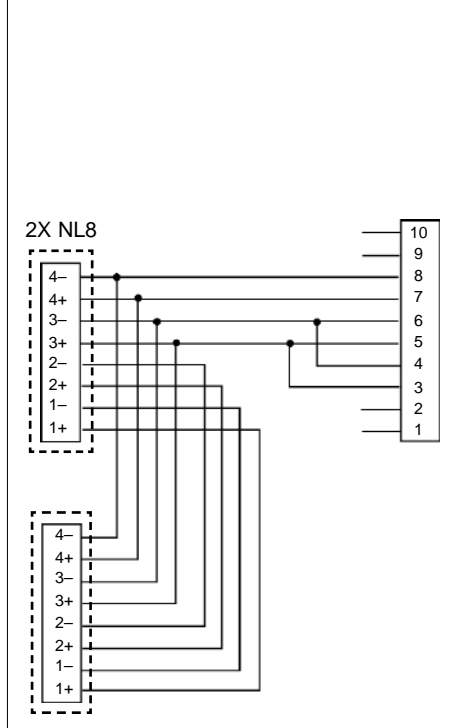

Wire Harness Assembly P/N 350986-001

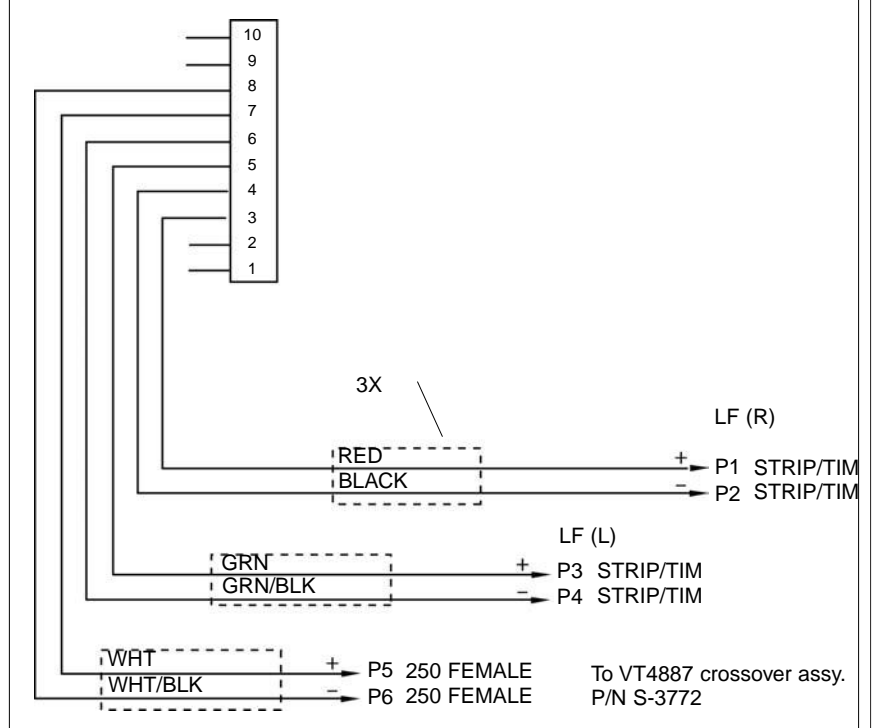

JBL VT4887

COMPONENT EXPLODED VIEW

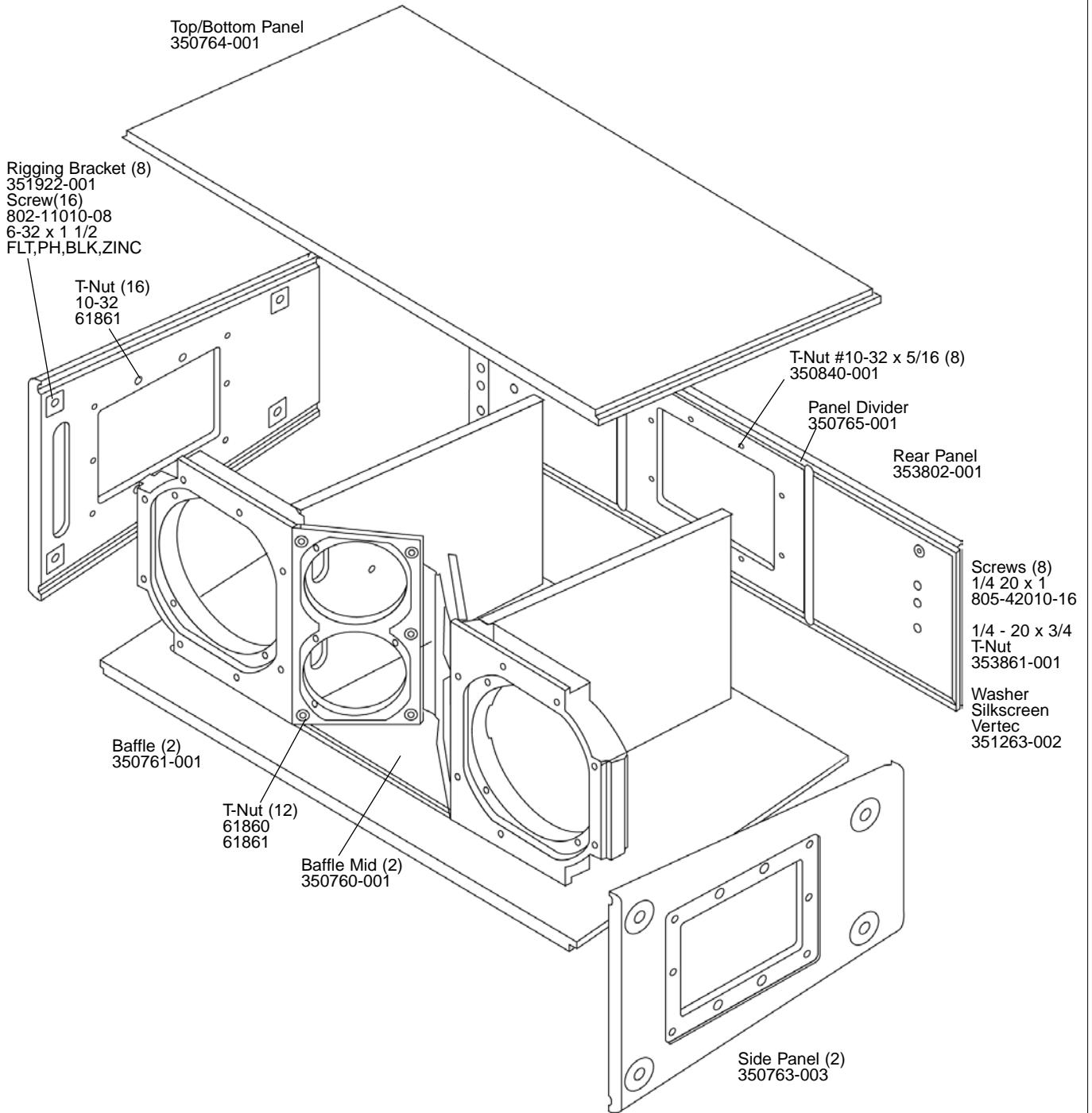

JBL VT4887

COMPONENT EXPLODED VIEW

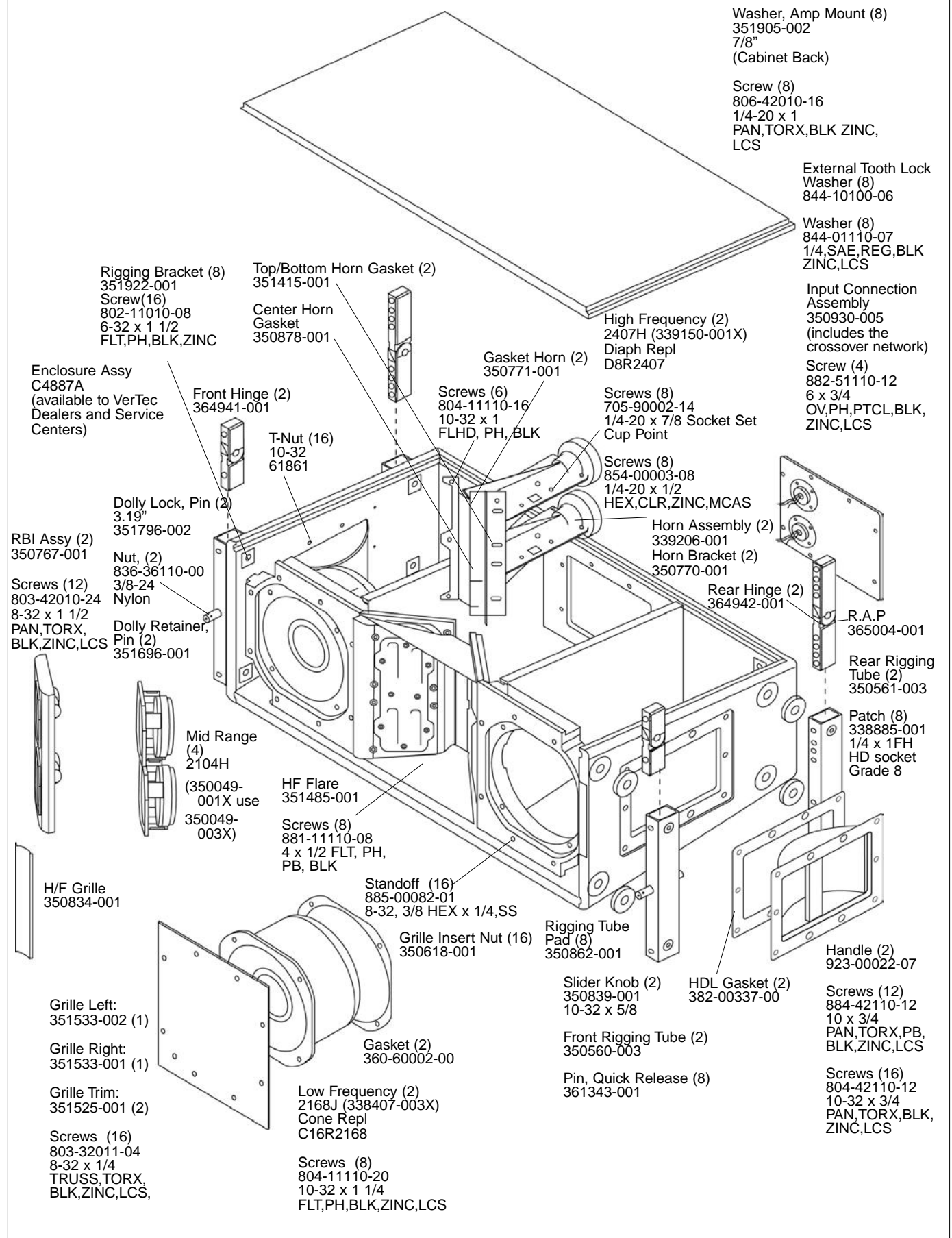

DOLLY ASSEMBLY

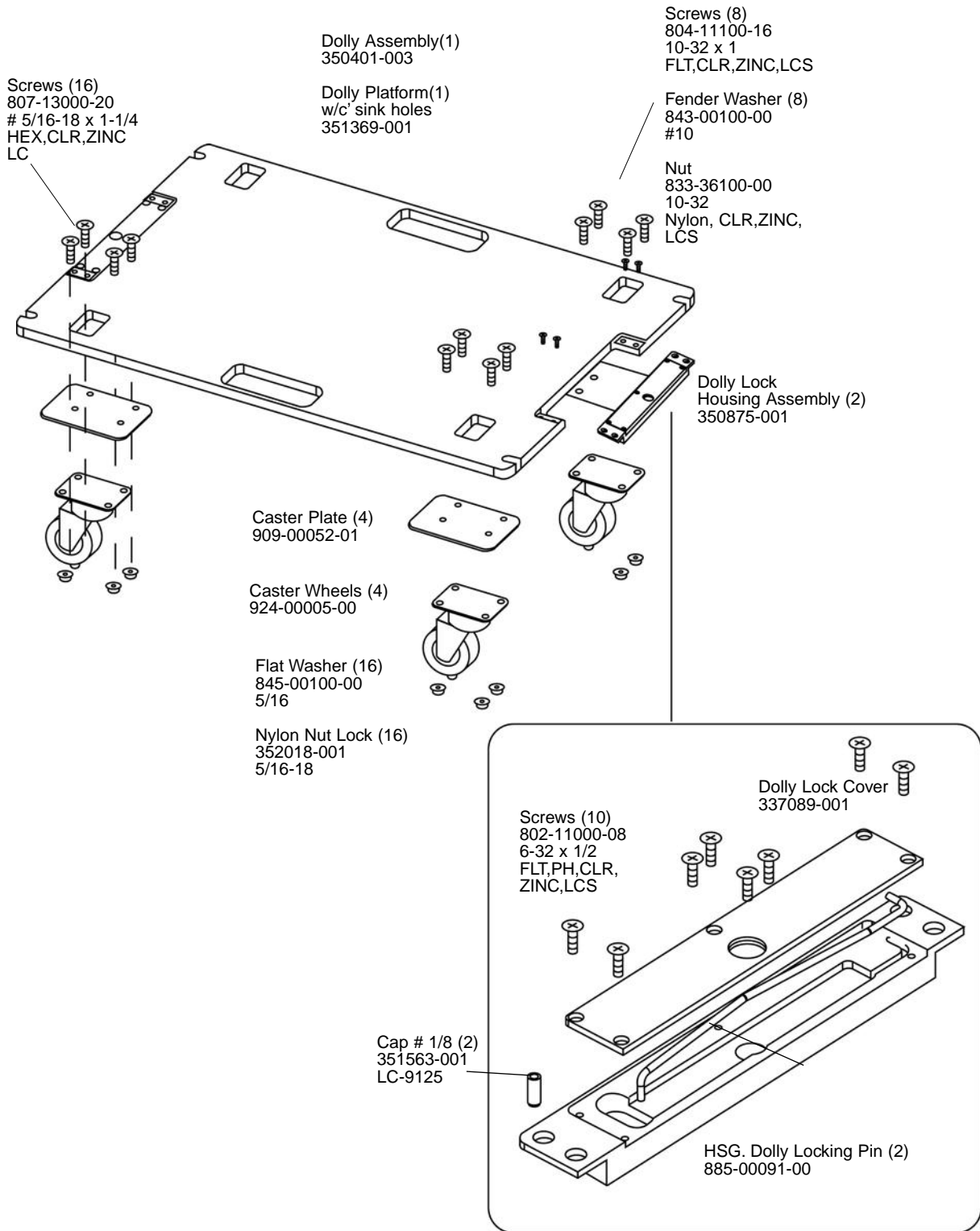

DOLLY ASSEMBLY

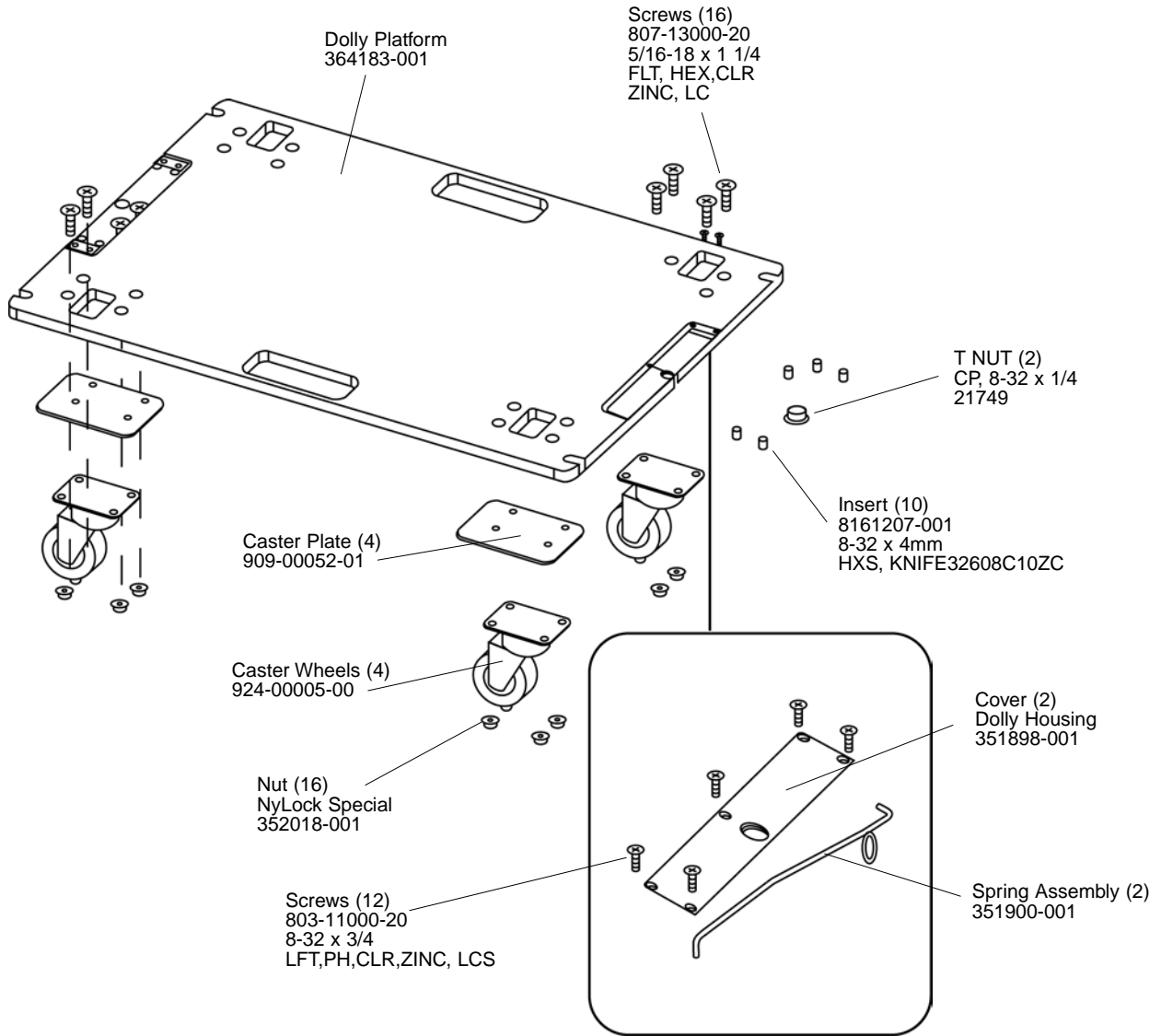

JBL VT4887-SF

ARRAY FRAME ASSEMBLY

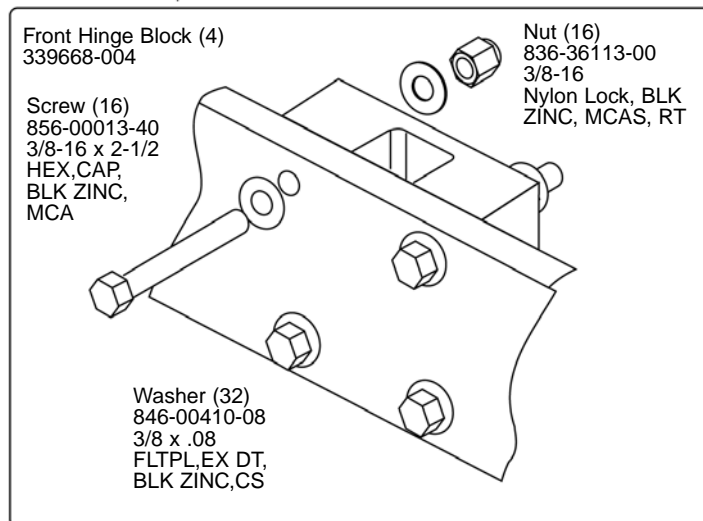
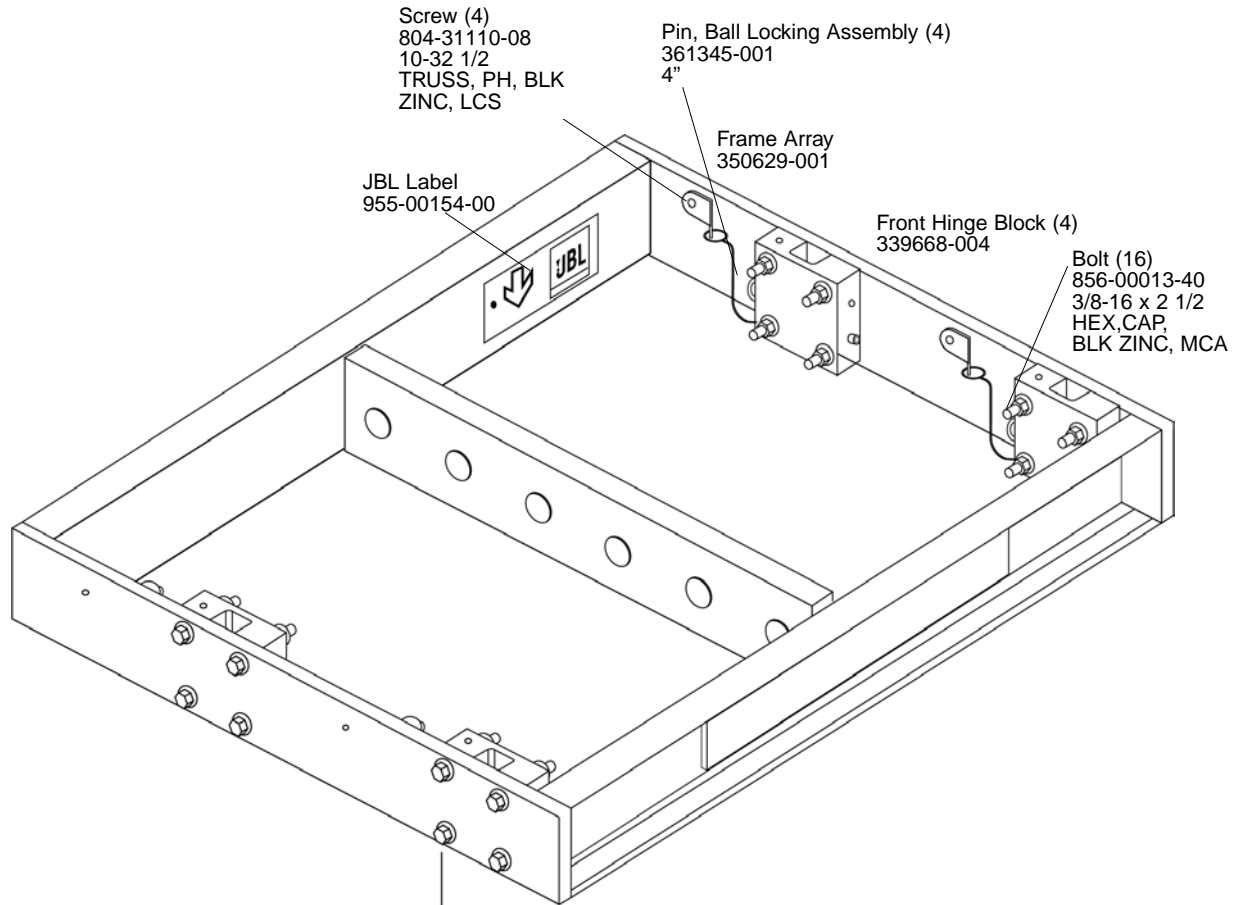

JBL VT4887-SF

JBL VT4887-AF

ARRAY FRAME ASSEMBLY

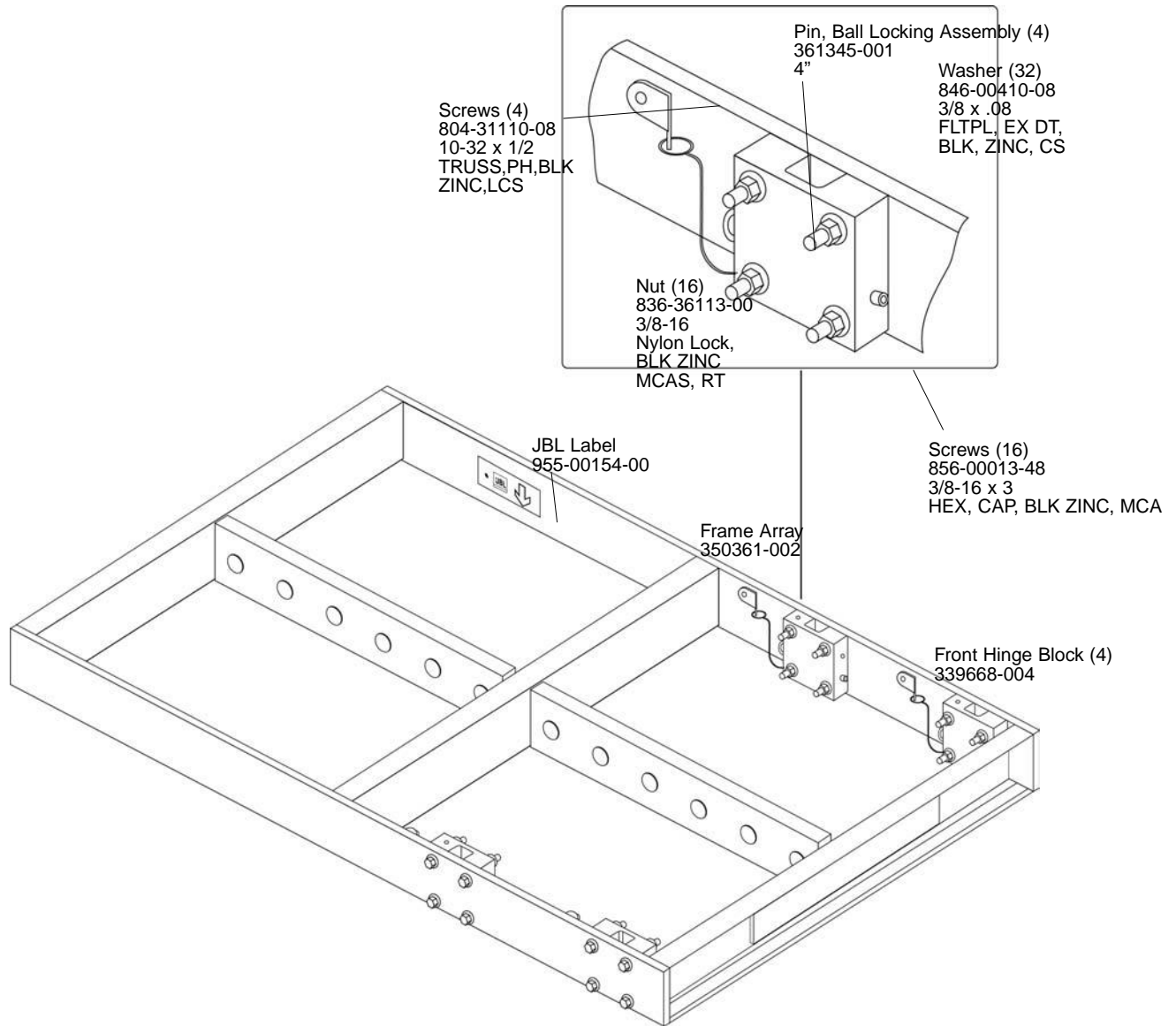

JBL VT4887-AF