

# Technical Manual

# JBL VT4888

## SPECIFICATIONS



### ACOUSTIC & ELECTRICAL SPECIFICATIONS:

- Frequency Response: 60 Hz- 16 kHz ( $\pm 3$  dB)
- Max Peak Output: 136 dB to 146 dB @ 1M  
(Frequency/Bandpass Dependent)
- Recommended Signal: Digital System Processing: dbx 480, BSS 366, XTA 226
- Horiz Coverage Angle: 90°, 250 Hz - 16 kHz (-6dB)
- Vert Coverage Angle: Varies with size and configuration(-6dB)
- Crossover Frequency: 315 Hz LF/Mid  
1.2 kHz MF/HF

### SYSTEMS COMPONENTS:

- Cabinet: Enclosure Assembly C4888
- Grille: Left (350780-002), Right (350780-001)
- Low Frequency Transducer: (2) 2262H, 304 mm (12") dia., 76 mm (3")  
Dual Coil Differential Drive
- Nominal Impedance: 8 ohms (Per Driver)
- Input Power Rating: 2000W (8000W peak) 2 hrs.  
1400W (5600W peak) 100 hrs.
- Bandpass Sensitivity: 98 dB,1W @ 1m (3.3 ft.)
- DC Resistance: 5.1 Ohms
- Mid Frequency Transducer: (4) 2106HPL, 50 mm (2") dia. Voice Coil
- Nominal Impedance: 8 Ohms (Per Driver)
- Input Power Rating: 600W (2400W peak) 100 hrs.  
400W (1600W peak) 100 hrs.
- Bandpass Sensitivity: 102 dB,1W @ 1m (3.3 ft.)
- DC Resistance: 4.3 Ohms

### SYSTEMS COMPONENTS (Cont):

- High Frequency Transducer: (2) 2431H, 76 mm (3") dia. Aluminium Diaphragm, 38mm (1.5") Throat Dia.
- Nominal Impedance: 8 ohms (Per Driver)
- Input Power Rating: 150W (600W peak) 100 hrs.
- Bandpass Sensitivity: 114 dB,1W @ 1m (3.3 ft.)
- DC Resistance: 4.0 Ohms

### AURAL SWEEP TEST SPECIFICATIONS:

- A. System Aural Sweep Test (thru processor measured as amp output): 6V, 40 Hz to 20 kHz
- B. LF Woofer Aural Sweep Test: 6V, 40 Hz to 1 kHz
- C. MF Woofer Aural Sweep Test: 3V, 400 Hz to 4 kHz
- D. HF Driver Aural Sweep Test: 1.5V, 800 Hz to 20 kHz

### PHYSICAL SPECIFICATIONS:

- Enclosure Dimensions: 355.6 mm x 990.6 mm x 508 mm D  
(14 x 39 x 20 in. D)
- Shipping Weight: VT4888 130 lbs. (59 kg)  
VT4888-ACC 30 lbs. (13.6 kg)

### WARRANTY INFORMATION:

- Refer to Warranty Statement packed with each product.

## PACKAGE

- Filler (1) 35862-001
- Microfoam (4) 49790P
- Carton 351861-001
- Fiberglass (13) 22389P
- Chip FBRBRD (38) 300982-001

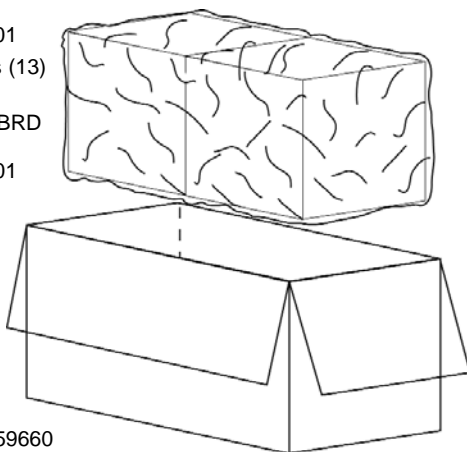

- Warranty 59660
- Specification Sheet 350620-001

- Dolly Assembly 350519-002
- Carton 350521-001

- Filler, Bottom (2) 350522-001
- Filler, Top (2) 351401-001

- Soft Cover 350520-001

- 910-00035-01 (1) Ferro fluid vial w/ blotter paper and instruction sheet

- 910-00035-02 (12) Ferro fluid vials w/ blotter paper and instruction sheet

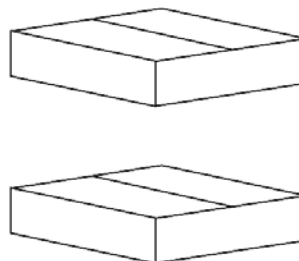

- JBL VT4888-AF Carton 350484-001
- Filler (2) 350486-001
- Owner's Manual 350485-001

- JBL VT4888-SF Carton 350706-001
- Filler (2) 350713-001
- Owner's Manual 350485-001

# JBL VT4888

## WIRING DIAGRAM

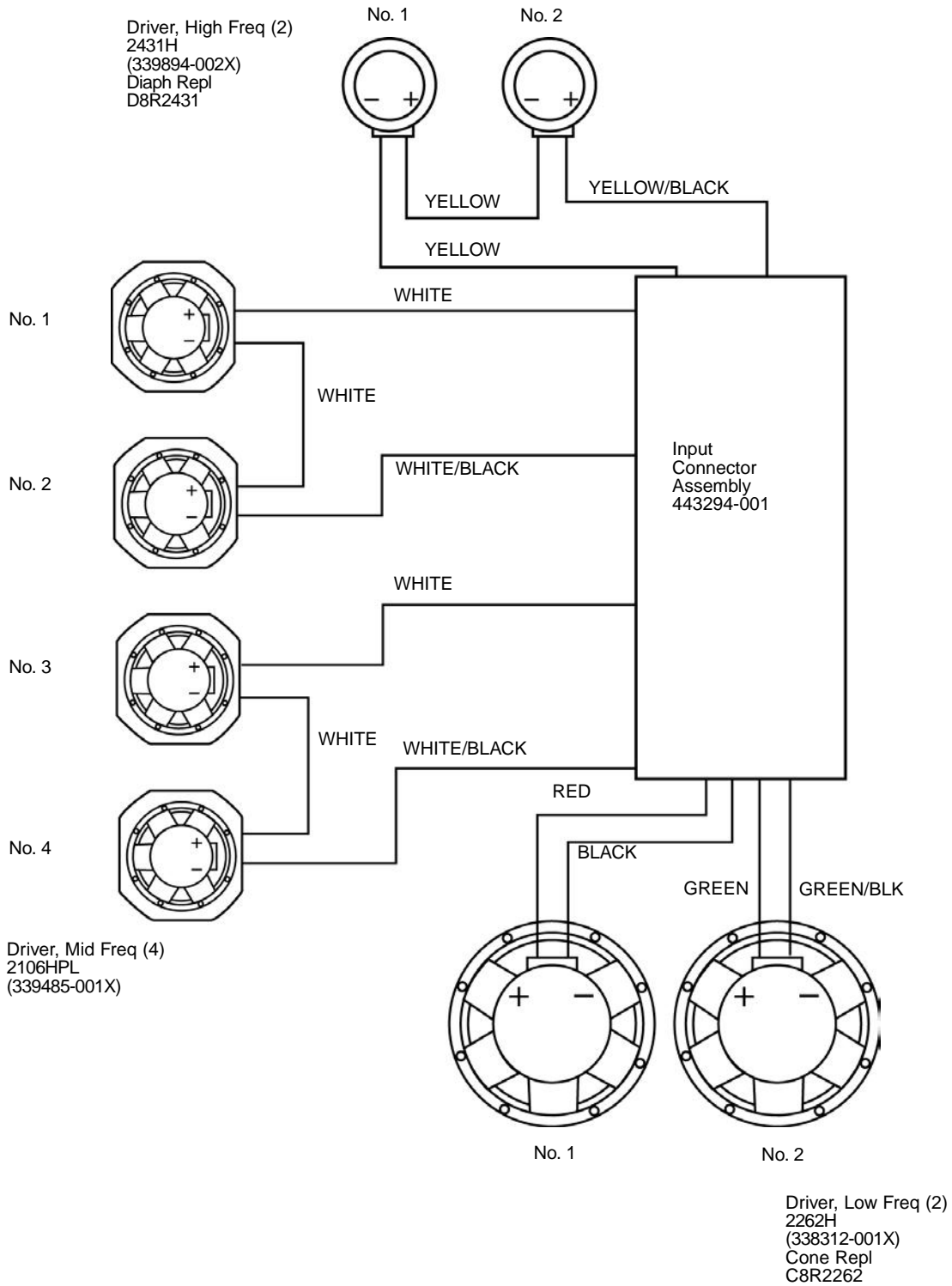

# JBL VT4888

## SCHEMATIC DIAGRAMS

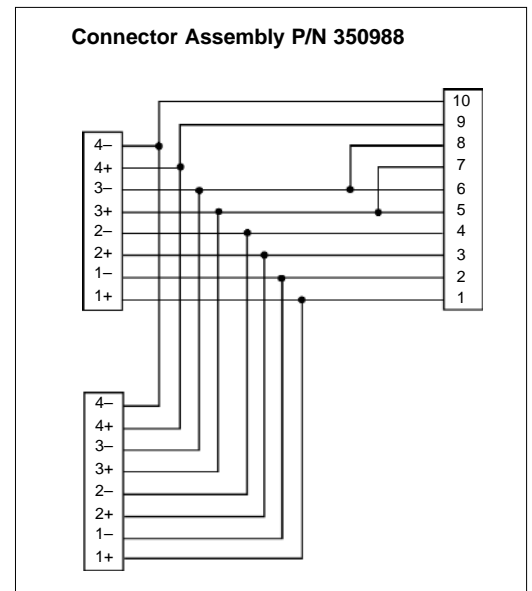
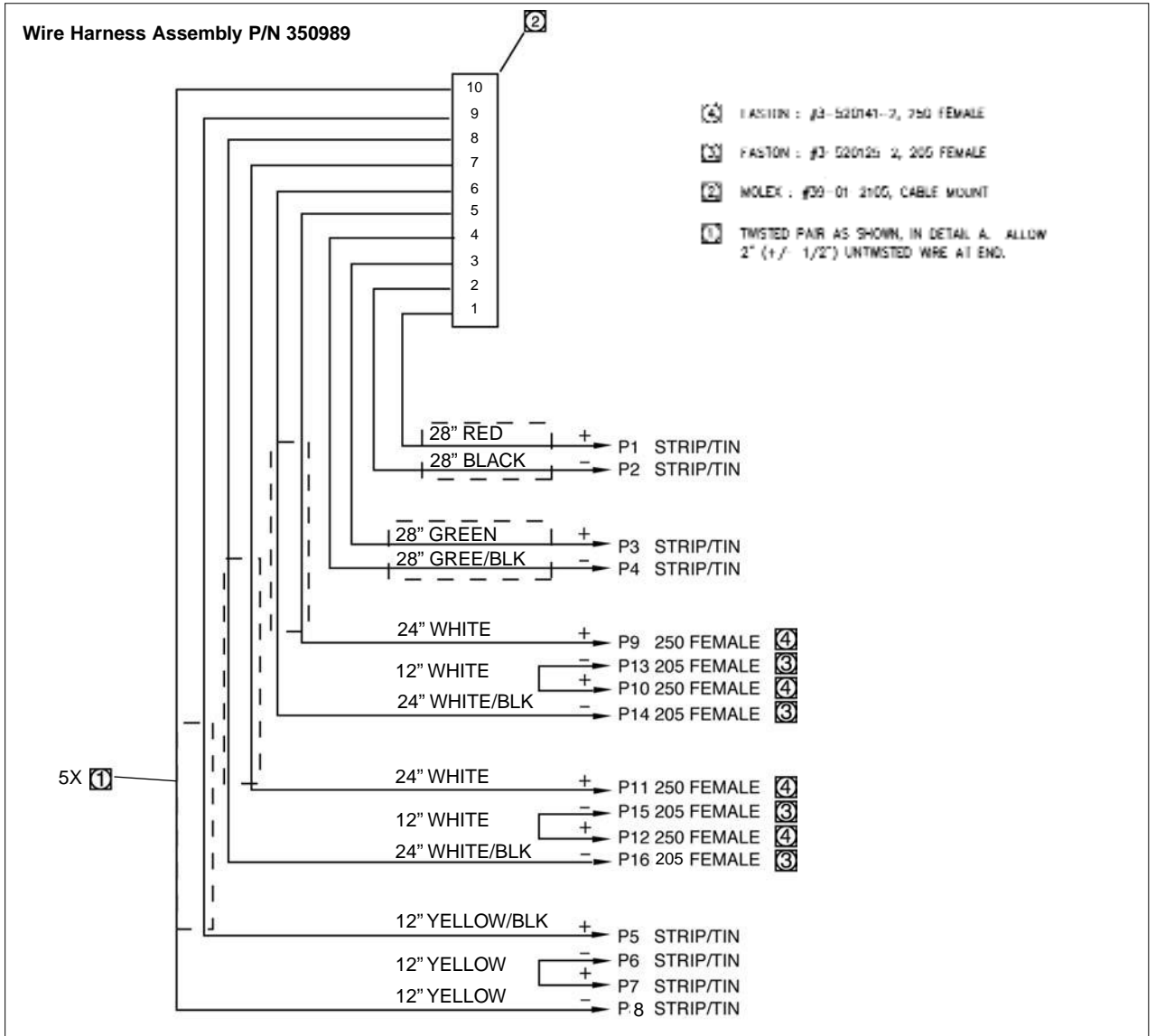

# JBL VT4888

## COMPONENT EXPLODED VIEW

Enclosure Assy  
C4888  
(available to VerTec  
Dealers and  
Service Centers)

HF Center Horn  
Gasket  
359-00225-00

Bolt, (8)  
854-00003-08  
1/4-20 x 1/2  
HEX, CLR, ZINC,  
MCAS

External Tooth Lock  
Washer (8) 1/4"  
844-10100-06  
REG, CLR, ZINC, CS

Washer (8)  
844-01110-07  
1/4,SAE,REG,BLK,  
ZINC,LCS

Front Hinge (2)  
364136-001

Slider Knob (2)  
350839-001  
10-32 x 5/8

Screws (32)  
804-72110-24  
10-32 x 1  
SKT, TORX,  
BLK, ZINC, LCS

RBI Assy (2)  
350779-001

Screw (2)  
804-72110-24  
10-32 x 1 1/2  
SCT,TORX,  
BLK ZINC,  
LCS

Driver, Mid Freq (4)  
2106H  
(339485-001X)

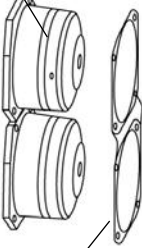

Mid-Range Gasket (2)  
350819-001

H/F Grille  
350827-001

Grille Right  
350780-001

Grille Left  
350780-002

Grille Trim (2)  
351526-001

Screws (16)  
803-32011-04  
8-32 x 1/4  
TRUSS,TORX,BLK  
ZINC,LCS

Standoff (16)  
885-00082-01  
8-32, 3/8  
HEX 1/4, SS

Driver, Low Freq  
2262H (2)  
(338312-001X)  
Cone Repl  
C8R2262

Screw (16)  
804-72110-24  
10-32 x 1 1/2  
SKT,TORX,BLK ZINC,  
LCS

Grille Insert Nut (16)  
350618-001

HF Flare  
351486-001

Screws (8)  
881-11110-08  
4 x 1/2  
FLT, PH, PB,  
BLK,ZINC

Dolly Lock Pin (2)  
351797-002

Nut (2)  
836-36110-00  
3/8-24  
Nylon,BLK, ZINC,  
LCS

Dolly Retainer, Pin  
(2) 351696-001

Gasket 12" (2)  
339391-001

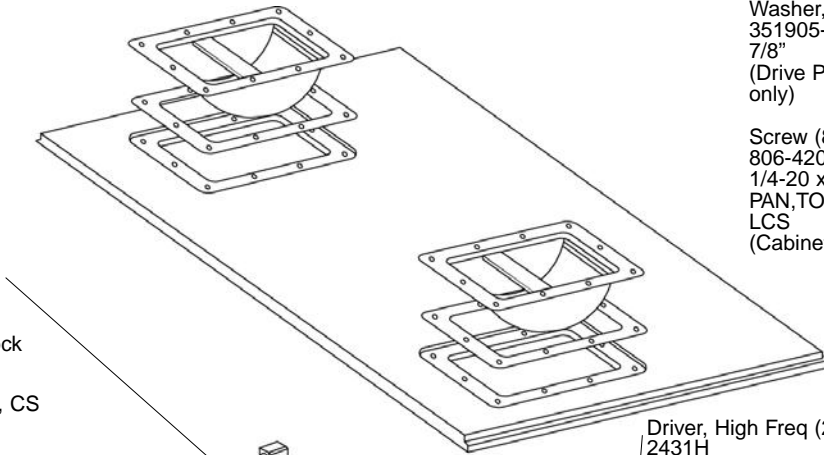

Washer, Amp Mount (8)  
351905-002  
7/8"  
(Drive Pack Attachment  
only)

Screw (8)  
806-42010-16  
1/4-20 x 1  
PAN,TORX,BLK ZINC,  
LCS  
(Cabinet Back)

Horn Bracket (2)  
350782-001

Screws (6)  
804-11110-16  
10-32 x 1  
FLT, PH, BLK,  
OXIDE, LCS

Horn (2)  
337055-001

Driver, High Freq (2)  
2431H  
(339894-002X)  
Diaph Repl  
D8R2431

Screw (8)  
705-90002-14  
1/4-20 x 7/8  
SOCKET SET  
CUP POINT

Screw (8)  
804-42110-12  
10-32 x 3/4  
PAN, TORX,  
BLK ZINC,  
LCS

Input  
Connector  
443294-001

Wire Harness  
350989-001

Connector  
Assembly  
350988-001

Nut (8)  
834-30010-00  
1/4-20  
KEPS, BLK ZINC,  
LCS,RIGHT

Threadlocker  
69437  
Locktite 242

Waveguide Gasket (2)  
350841-001

Horn Gasket  
Top/Bottom (2)  
351415-001

Rear Hinge  
Assy. (2)  
364137-001

Screws (4)  
338885-001  
1/4 x 1 FLTHD  
Socket Grade  
8,PATCH

Quick Release  
Pin, (8)  
361343-001

Rear Rigging  
Tube (2)  
350573-002

Handle (6)  
923-00022-07

Gasket (6)  
382-00337-00  
Handle

Front Rigging  
Tube (2)  
350572-002

Screw (4)  
338885-001  
1/4 x 1  
FLTHD  
SOCKET GRD  
8, PATCH

Screws (24)  
804-42110-12  
10-32 x3/4  
PAN,TORX,BLK  
ZINC,LCS

Screws (36)  
884-42110-12  
10 X 3/4  
PAN, TORX, PB, BLK,  
ZINC, LCS

# JBL VT4888-ACC

## DOLLY ASSEMBLY

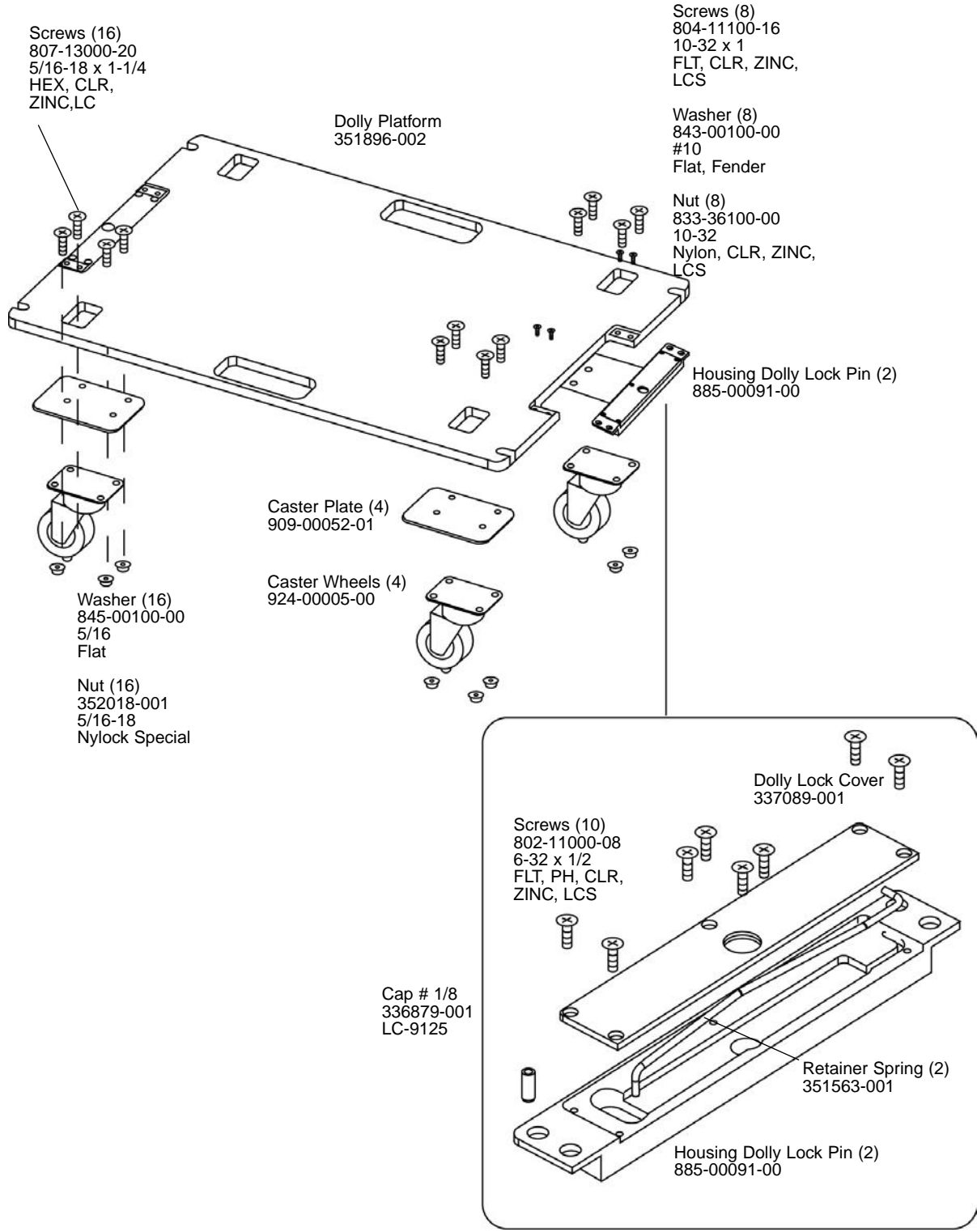

# JBL VT4888-ACC

REV B

## DOLLY ASSEMBLY 350519-002

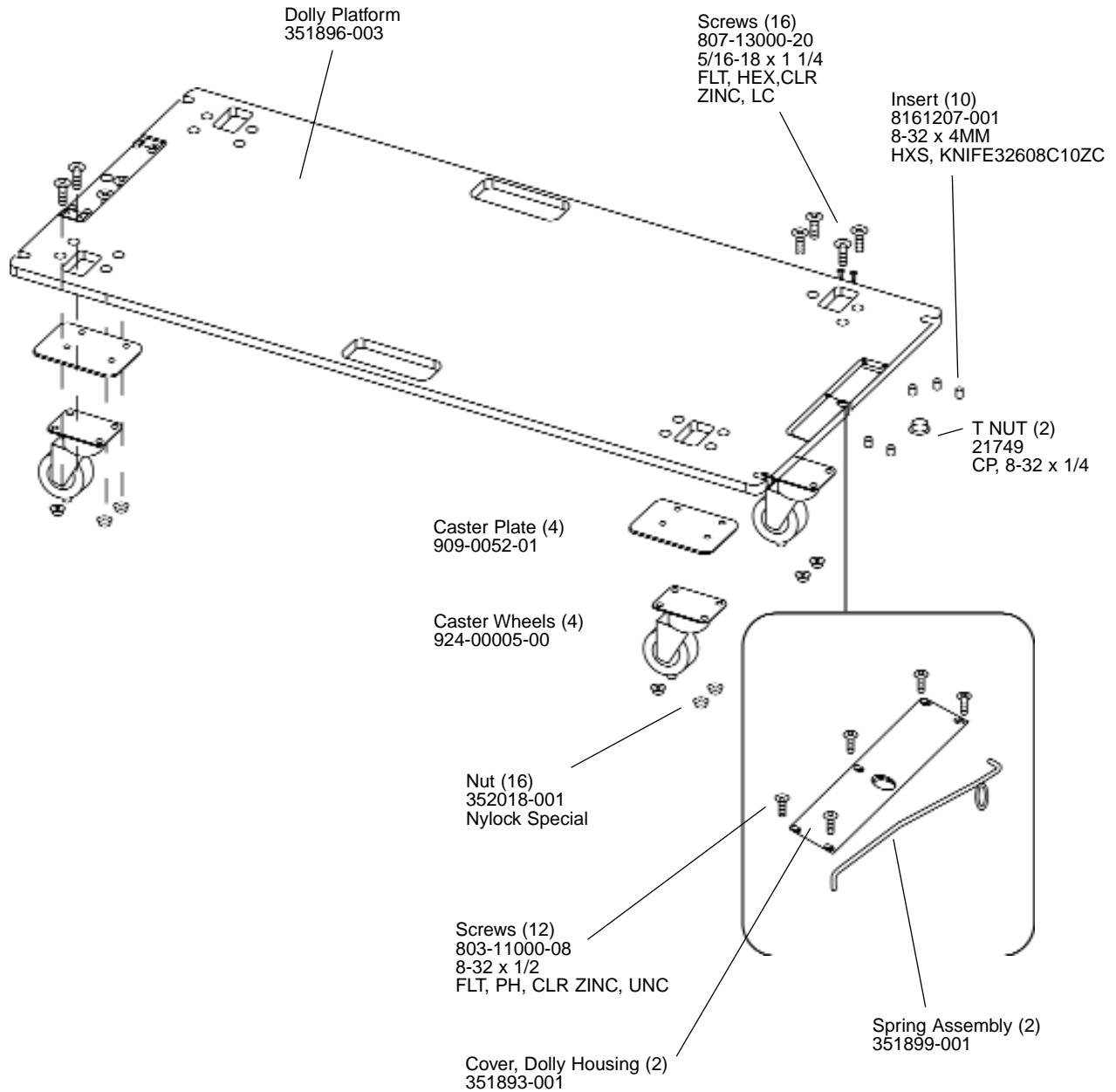

JBL VT4888-ACC

# JBL VT4888-SF

## ARRAY FRAME ASSEMBLY

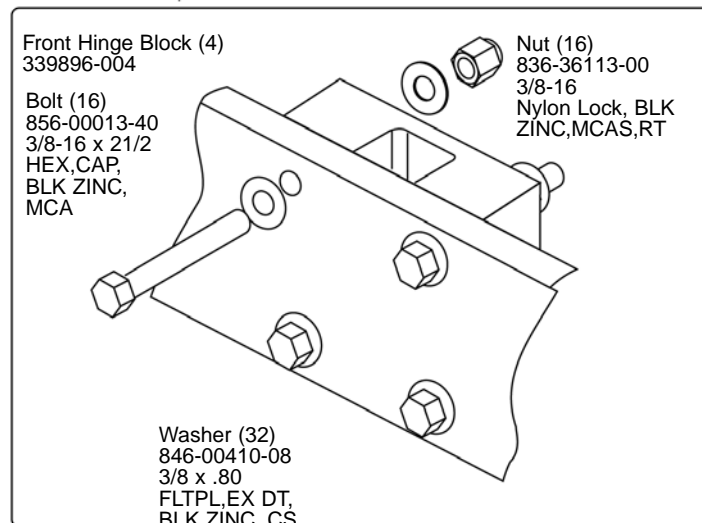
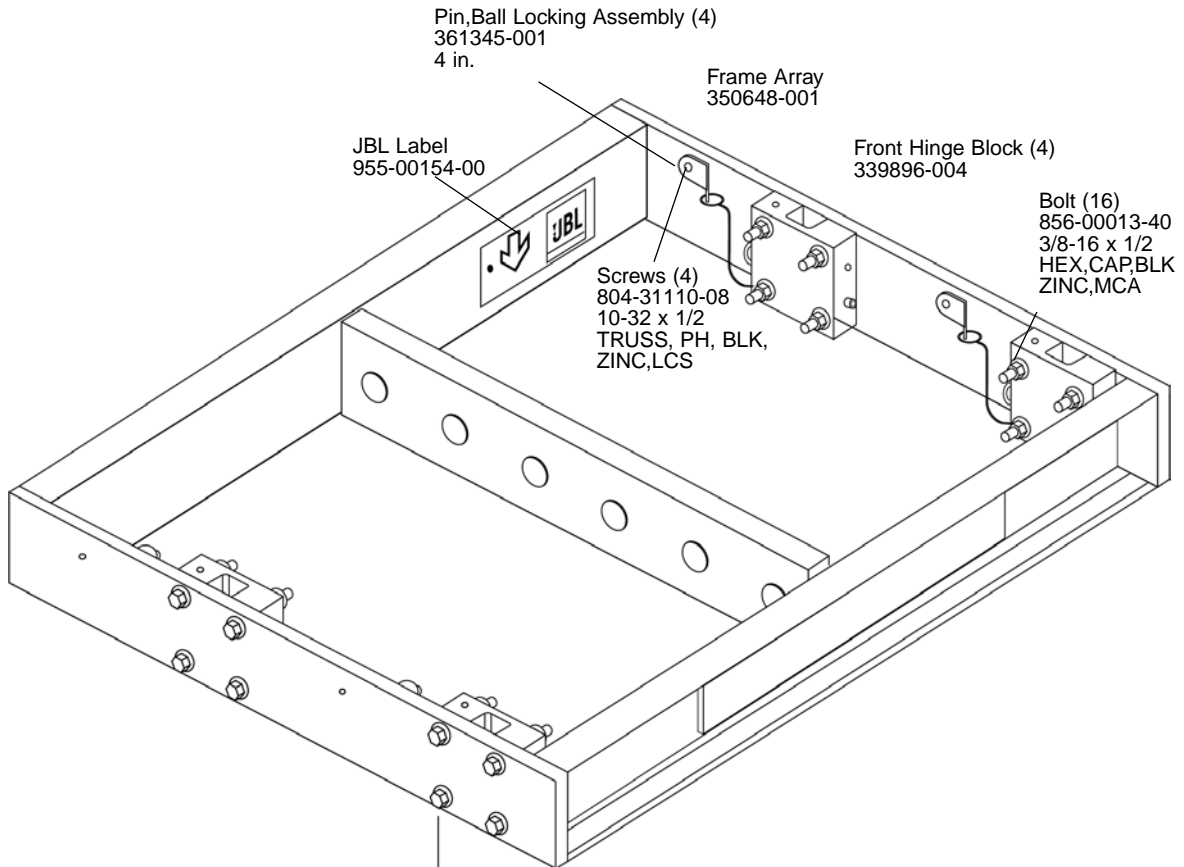

# JBL VT4888-AF

## ARRAY FRAME ASSEMBLY

