

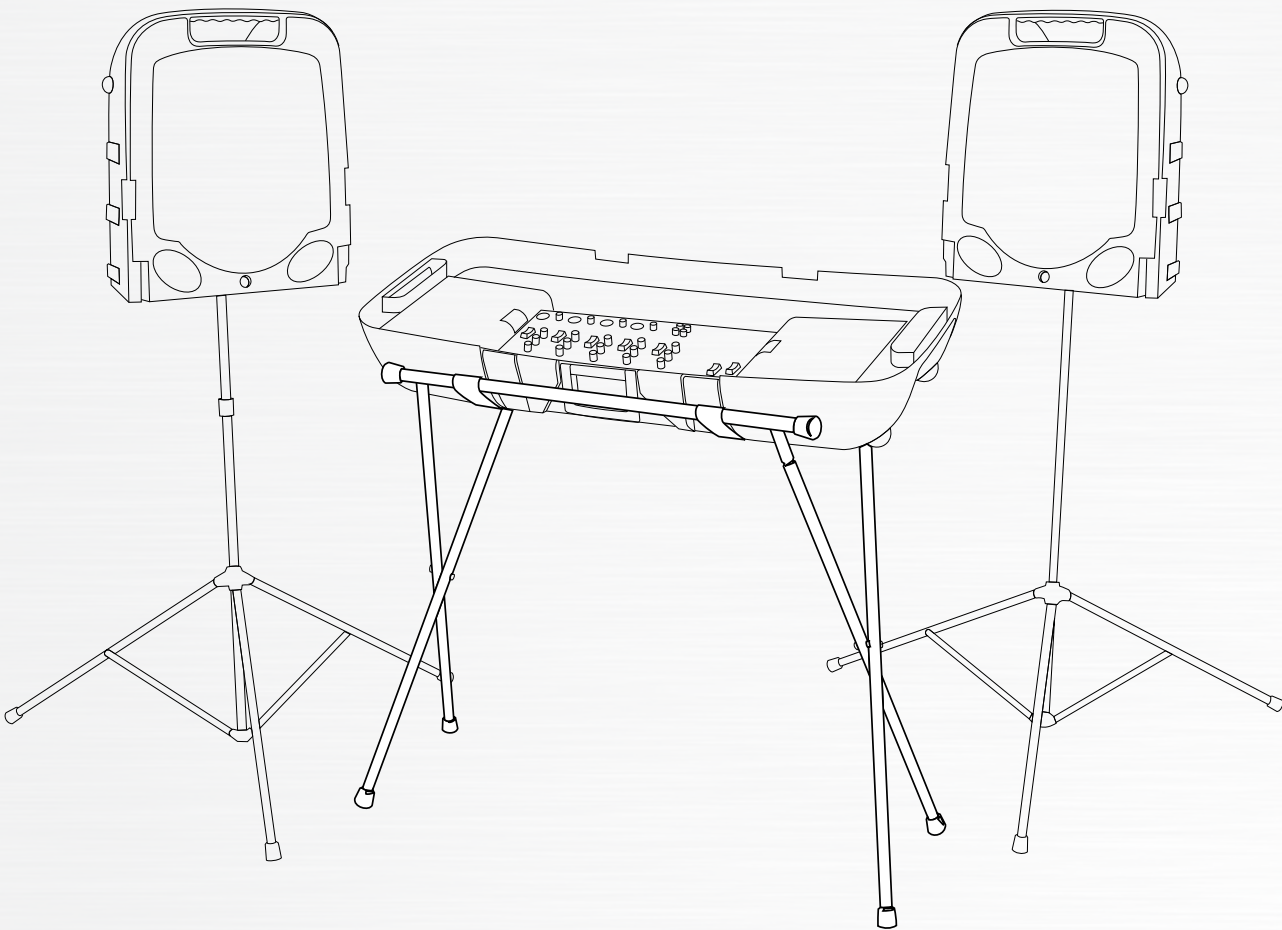

Escort® 3000 Portable PA System

Operating Manual





Intended to alert the user to the presence of uninsulated “dangerous voltage” within the product’s enclosure that may be of sufficient magnitude to constitute a risk of electric shock to persons.



Intended to alert the user of the presence of important operating and maintenance (servicing) instructions in the literature accompanying the product.

CAUTION: Risk of electrical shock — DO NOT OPEN!

CAUTION: To reduce the risk of electric shock, do not remove cover. No user serviceable parts inside. Refer servicing to qualified service personnel.

WARNING: To prevent electrical shock or fire hazard, this apparatus should not be exposed to rain or moisture, and objects filled with liquids, such as vases, should not be placed on this apparatus. Before using this apparatus, read the operating guide for further warnings.



Protective earthing terminal. The apparatus should be connected to a mains socket outlet with a protective earthing connection.



Este símbolo tiene el propósito, de alertar al usuario de la presencia de “(voltaje) peligroso” sin aislamiento dentro de la caja del producto y que puede tener una magnitud suficiente como para constituir riesgo de descarga eléctrica.



Este símbolo tiene el propósito de alertar al usuario de la presencia de instrucciones importantes sobre la operación y mantenimiento en la información que viene con el producto.

PRECAUCION: Riesgo de descarga eléctrica ¡NO ABRIR!

PRECAUCION: Para disminuir el riesgo de descarga eléctrica, no abra la cubierta. No hay piezas útiles dentro. Deje todo mantenimiento en manos del personal técnico cualificado.

ADVERTENCIA: Para prevenir choque eléctrico o riesgo de incendios, este aparato no se debe exponer a la lluvia o a la humedad. Los objetos llenos de líquidos, como los floreros, no se deben colocar encima de este aparato. Antes de usar este aparato, lea la guía de funcionamiento para otras advertencias.



Terminal de puesta a tierra de protección. El aparato debe estar conectado a una toma de corriente con conexión a tierra de protección.



Ce symbole est utilisé dans ce manuel pour indiquer à l'utilisateur la présence d'une tension dangereuse pouvant être d'amplitude suffisante pour constituer un risque de choc électrique.



Ce symbole est utilisé dans ce manuel pour indiquer à l'utilisateur qu'il ou qu'elle trouvera d'importantes instructions concernant l'utilisation et l'entretien de l'appareil dans le paragraphe signalé.

ATTENTION: Risques de choc électrique — NE PAS OUVRIR!

ATTENTION: Afin de réduire le risque de choc électrique, ne pas enlever le couvercle. Il ne se trouve à l'intérieur aucune pièce pouvant être réparée par l'utilisateur. Confiez l'entretien et la réparation de l'appareil à un réparateur Peavey agréé.

AVIS: Dans le but de réduire les risques d'incendie ou de décharge électrique, cet appareil ne doit pas être exposé à la pluie ou à l'humidité et aucun objet rempli de liquide, tel qu'un vase, ne doit être posé sur celui-ci. Avant d'utiliser de cet appareil, lisez attentivement le guide fonctionnant pour avertissements supplémentaires.



Borne de terre de protection. L'appareil doit être connecté à une prise secteur avec une connexion à la terre.



Dieses Symbol soll den Anwender vor unisolierten gefährlichen Spannungen innerhalb des Gehäuses warnen, die von Ausreichender Stärke sind, um einen elektrischen Schlag verursachen zu können.



Dieses Symbol soll den Benutzer auf wichtige Instruktionen in der Bedienungsanleitung aufmerksam machen, die Handhabung und Wartung des Produkts betreffen.

VORSICHT: Risiko — Elektrischer Schlag! Nicht öffnen!

VORSICHT: Um das Risiko eines elektrischen Schlages zu vermeiden, nicht die Abdeckung entfernen. Es befinden sich keine Teile darin, die vom Anwender repariert werden könnten. Reparaturen nur von qualifiziertem Fachpersonal durchführen lassen.

WARNUNG: Um elektrischen Schlag oder Brandgefahr zu verhindern, sollte dieser Apparat nicht Regen oder Feuchtigkeit ausgesetzt werden und Gegenstände mit Flüssigkeiten gefüllt, wie Vasen, nicht auf diesen Apparat gesetzt werden. Bevor dieser Apparat verwendet wird, lesen Sie bitte den Funktionsführer für weitere Warnungen.



Schutzerdung Terminal. Das Gerät nur an Steckdose mit Schutzleiter angeschlossen werden.



Tarkoitettu kiinnittämään käyttäjän huomio sellaiseen eristämättömään vaaralliseen jännitteeseen tuotteen kotelossa, joka saattaa olla riittävän suuri aiheuttaakseen sähköiskuvaaran.



Tarkoitettu kiinnittämään käyttäjän huomio tärkeisiin käyttö- ja huolto-ohjeisiin tuotteen mukana seuraavassa ohjeistuksessa.

VAROITUS: Sähköiskun vaara — ÄLÄ AVAA!

VAROITUS: Sähköiskuvaaran vuoksi älä poista kantta. Ei sisällä käyttäjän huollettavissa olevia osia. Huoltaminen tulee jättää pätevän huoltohenkilöstön tehtäväksi.

VAARA: Sähköiskun tai tulipalon vaaran estämiseksi tätä laitetta ei saa altistaa sateelle tai kosteudelle, eikä sen päälle saa asettaa nesteellä täytettyjä esineitä, kuten maljakoita. Ennen laitteen käyttöä lue muut varoitukset käyttöohjeesta.



Suojamaadoitus terminaali. Laitte tulee kytkeä sähköverkkoon suojajohtimella.

IMPORTANT SAFETY INSTRUCTIONS

WARNING: When using electrical products, basic cautions should always be followed, including the following:

1. Read these instructions.
2. Keep these instructions.
3. Heed all warnings.
4. Follow all instructions.
5. Do not use this apparatus near water.
6. Clean only with a dry cloth.
7. Do not block any of the ventilation openings. Install in accordance with manufacturer's instructions.
8. Do not install near any heat sources such as radiators, heat registers, stoves or other apparatus (including amplifiers) that produce heat.
9. Do not defeat the safety purpose of the polarized or grounding-type plug. A polarized plug has two blades with one wider than the other. A grounding type plug has two blades and a third grounding plug. The wide blade or third prong is provided for your safety. If the provided plug does not fit into your outlet, consult an electrician for replacement of the obsolete outlet.
10. Protect the power cord from being walked on or pinched, particularly at plugs, convenience receptacles, and the point they exit from the apparatus.
11. Only use attachments/accessories provided by the manufacturer.
12.  Use only with a cart, stand, tripod, bracket, or table specified by the manufacturer, or sold with the apparatus. When a cart is used, use caution when moving the cart/apparatus combination to avoid injury from tip-over.
13. Unplug this apparatus during lightning storms or when unused for long periods of time.
14. Refer all servicing to qualified service personnel. Servicing is required when the apparatus has been damaged in any way, such as power-supply cord or plug is damaged, liquid has been spilled or objects have fallen into the apparatus, the apparatus has been exposed to rain or moisture, does not operate normally, or has been dropped.
15. Never break off the ground pin. Write for our free booklet "Shock Hazard and Grounding." Connect only to a power supply of the type marked on the unit adjacent to the power supply cord.
16. If this product is to be mounted in an equipment rack, rear support should be provided.
17. Note for UK only: If the colors of the wires in the mains lead of this unit do not correspond with the terminals in your plug, proceed as follows: a) The wire that is colored green and yellow must be connected to the terminal that is marked by the letter E, the earth symbol, colored green or colored green and yellow. b) The wire that is colored blue must be connected to the terminal that is marked with the letter N or the color black. c) The wire that is colored brown must be connected to the terminal that is marked with the letter L or the color red.
18. This electrical apparatus should not be exposed to dripping or splashing and care should be taken not to place objects containing liquids, such as vases, upon the apparatus.
19. The on/off switch in this unit does not break both sides of the primary mains. Hazardous energy can be present inside the chassis when the on/off switch is in the off position. The mains plug or appliance coupler is used as the disconnect device, the disconnect device shall remain readily operable.
20. Exposure to extremely high noise levels may cause a permanent hearing loss. Individuals vary considerably in susceptibility to noise-induced hearing loss, but nearly everyone will lose some hearing if exposed to sufficiently intense noise for a sufficient time. The U.S. Government's Occupational Safety and Health Administration (OSHA) has specified the following permissible noise level exposures:



| Duration Per Day In Hours | Sound Level dBA, Slow Response |
|---------------------------|--------------------------------|
| 8 | 90 |
| 6 | 92 |
| 4 | 95 |
| 3 | 97 |
| 2 | 100 |
| 1 1/2 | 102 |
| 1 | 105 |
| 1/2 | 110 |
| 1/4 or less | 115 |

According to OSHA, any exposure in excess of the above permissible limits could result in some hearing loss. Earplugs or protectors to the ear canals or over the ears must be worn when operating this amplification system in order to prevent a permanent hearing loss, if exposure is in excess of the limits as set forth above. To ensure against potentially dangerous exposure to high sound pressure levels, it is recommended that all persons exposed to equipment capable of producing high sound pressure levels such as this amplification system be protected by hearing protectors while this unit is in operation.

SAVE THESE INSTRUCTIONS!

 Logo referenced in Directive 2002/96/EC Annex IV(OJ(L)37/38, 13.02.03 and defined in EN 50419: 2005

The bar is the symbol for marking of new waste and is applied only to equipment manufactured after 13 August 2005

Correct Disposal of this product. This marking indicates that this product should not be disposed with other household wastes throughout the EU. To prevent possible harm to the environment or human health from uncontrolled waste disposal, recycle it responsibly to promote the sustainable reuse of material resources. To return your used device, please use the return and collection systems, or contact the retailer where the product was purchased. They can take this product for environmental safe recycling.

 Logotipo al que se hace referencia en la Directiva 2002/96/EC AnexoIV(OJ(L)37/38, 13.02.03 y definido en EN 50419: 2005

La barra es el símbolo para marcar los nuevos desechos y se aplica solamente a equipamiento fabricado después del 13 de agosto de 2005

Forma correcta de deshacerse de este producto. Esta marca indica que este producto no debe arrojarse junto con otros desperdicios domésticos en ningún lugar de la Unión Europea. Para evitar posibles daños al medio ambiente o a la salud humana debidos a desechos no controlados de desperdicios, reciclelo responsablemente para promover la reutilización sostenible de los recursos materiales. Para devolver su dispositivo usado, utilice los sistemas de devolución recolección, o contacte con el vendedor minorista donde compró el producto. Ellos pueden llevar este producto al reciclado seguro para el medio ambiente.

 Logo documenté dans l'annexe de la Directive 2002/96/EC IV_(OJ(L)37/38, 13.02.03 et défini par la norme EN 50419:2005

La barre est le symbole de signalisation des nouveaux déchets qui s'applique uniquement aux équipements fabriqués après le 13 août 2005

Recyclez correctement ce produit. Cette signalisation indique que ce produit ne doit pas être jeté avec les autres déchets domestiques dans les pays de l'UE. Pour éviter toute atteinte à l'environnement ou à la santé humaine par des décharges sauvages, recyclez ce produit de manière responsable pour encourager la réutilisation durable des ressources matérielles. Pour retourner votre appareil usé, veuillez utiliser les systèmes de collecte et de retour, ou contactez le revendeur à qui vous avez acheté le produit. Il prendra en charge ce produit de manière à protéger l'environnement.

 Logo eingetragen in Richtlinie 2002/96/EG Anhang IV_(OJ(L)37/38, 13.02.03 und definiert in EN 50419: 2005

Der Balken ist das Symbol zur Kennzeichnung neuen Abfalls und wird nur auf Geräten angebracht, die nach dem 13. August 2005 gefertigt wurden

Entsorgen Sie dieses Produkt umweltgerecht. Diese Kennzeichnung bedeutet, dass das Produkt innerhalb der EU nicht mit dem Hausmüll entsorgt werden darf. Zur Vermeidung von Umwelt- und Gesundheitsschäden durch unkontrollierte Entsorgung recyceln Sie das Gerät bitte. Geben Sie das Gerät an einer Sammelstelle für Elektroaltgeräte ab oder wenden Sie sich an Ihren Fachhändler.

 Logo viitattu direktiivin 2002/96/EY liitteen IV(OJ(L)37/38, 13.02.03 mukaisesti, määritely standardissa EN 50419: 2005

Palkki on uuden jätteen merkintäsymboli ja sitä käytetään vain 13. elokuuta 2005 jälkeen valmistetuissa laitteissa

Tuotteen oikea hävittäminen. Tämä merkki ilmaisee, että tuotetta ei saa hävittää muun talousjätteen mukana EU:n alueella. Jotta estetään mahdolliset valvomattoman jätteiden hävittämisen haitat ympäristölle tai ihmisten terveydelle, kierrätä tuote vastuullisesti ja edistä materiaalien kestävää uudelleenkäyttöä. Voit palauttaa käytetyn laitteen käyttämällä keräysjärjestelmiä tai ottamalla yhteyttä jälleenmyyjään, jolta laite ostettiin. He voivat toimittaa tuotteen ympäristön kannalta turvallisesti kierrätykseen.

 Logotyp som hänvisar till i direktiv 2002/96/EG bilaga IV(OJ(L)37/38, 13.02.03 och definieras i EN 50419: 2005

Stapeln är symbolen för märkning av nytt avfall och är endast tillämplig på utrustning som tillverkats efter 13 augusti, 2005

Korrekt bortscaffande av denna produkt. Denna märkning betyder att produkten inte skall bortscaffas tillsammans med annat hushållsavfall i hela EU. För att förhindra eventuella skador för miljön eller människors hälsa från okontrollerat bortscaffande av avfall, återvinn det ansvarsfullt för att främja hållbar återanvändning av materiella resurser. För att returnera din använda enhet, använd återanvändnings- och uppsamlingsystem, eller kontakta den återförsäljare där produkten köptes. De kan ta hand om denna produkt för miljösäker återvinning.

 Het logo waarnaar wordt verwezen in de bijlage van Richtlijn 2002/96/EG IV(OJ(L)37/38, 13.02.03 en omschreven in EN 50419: 2005

De balk is het symbool voor het markeren van nieuw afval en wordt alleen toegepast op apparatuur dat is vervaardigd na 13 augustus 2005

Juiste verwijdering van dit product. Deze markering geeft aan dat dit product nergens in de Europese Unie met ander huishoudelijk afval mag worden afgevoerd. Om mogelijke schade aan het milieu of gezondheid door ongecontroleerde afvalverwijdering te voorkomen, recycle het op een verantwoorde wijze om het duurzame hergebruik van materiaalgrondstoffen te bevorderen. Om uw gebruikte apparaat in te leveren, kunt u gebruik maken van de inlever- en verzamelstystemen of contact opnemen met de verkoper waar het product is gekocht. Zij kunnen dit product innemen voor het milieuvriendelijk recycling.

 Simbolo presente nell'allegato IV_(OJ(L)37/38, 13.02.03 della direttiva 2002/96/CE e definito nello standard EN 50419: 2005

La barra è il simbolo indicante un nuovo rifiuto ed è applicata esclusivamente ad apparecchiature prodotte successivamente al 13 agosto 2005

Corretto smaltimento di questo prodotto. Questo simbolo indica che questo prodotto non deve essere smaltito insieme ad altri rifiuti domestici in tutta Europa. Per prevenire possibili danni all'ambiente o alla salute umana dovuti allo smaltimento non regolamentato dei rifiuti, è necessario riciclarlo responsabilmente al fine di promuovere il riutilizzo sostenibile delle risorse materiali. Per restituire il dispositivo usato, utilizzare i sistemi di restituzione e raccolta o contattare il rivenditore presso il quale il prodotto è stato acquistato. Quest'ultimo può occuparsi del riciclaggio ambientale sicuro di questo prodotto.

 标志参照 2002/96/EC 指令附录 IV(OJ(L)37/38, 13.02.03 和 EN 50419: 2005 定义

条形码标示新废弃物, 仅适用于 2005 年 8 月 13 日后生产的设备

正确处理此产品。此标志表明该产品在整个欧盟区内不应该与其他家居生活废弃物一同处置。为防止因无控废弃物处置对环境或人类健康可能造成的危害, 请负责地回收并促进可重复使用的物质资源。要返还旧设备, 请使用返回收集系统, 或联系购买此产品的零售商。他们会为环境安全回收此产品。



FCC Compliance Statement

This device complies with Part 15 of the FCC rules. Operation is subject to the following two conditions: (1) this device may not cause harmful interference, and (2) this device must accept any interference received, that may cause undesired operation.

Warning: Changes or modifications to the equipment not approved by Peavey Electronics Corp. can void the user's authority to use the equipment.

Note - This equipment has been tested and found to comply with the limits for a Class B digital device, pursuant to Part 15 of the FCC Rules. These limits are designed to provide reasonable protection against harmful interference in a residential installation. This equipment generates, uses and can radiate radio frequency energy and, if not installed and used in accordance with the instructions, may cause harmful interference to radio communications. However, there is no guarantee that interference will not occur in a particular installation. If this equipment does cause harmful interference to radio or television reception, which can be determined by turning the equipment off and on, the user is encouraged to try and correct the interference by one or more of the following measures.

- Reorient or relocate the receiving antenna.
- Increase the separation between the equipment and receiver.
- Connect the equipment into an outlet on a circuit different from that to which the receiver is connected.
- Consult the dealer or an experienced radio/TV technician for help.



Escort® 3000

Portable Pro Audio System

Congratulations! You have just purchased the world's finest portable PA system. The Escort's integrated design allows for ease of transport, while its user-friendly controls offer ease of operation, making it the perfect choice for schools, churches, civic organizations as well as DJ's and small musical groups. The Escort features dual two-way speakers driven by a seven-channel, powered mixer, making it ideal for vocal, musical and DJ applications. The mixer includes a media channel with several inputs for multiple playback options, as well as professional quality features such as a digital effects section, footswitchable effects defeat and a master seven-band graphic EQ with FLS® (Feedback Locating System). The carrying case provides additional storage for microphones, cables and whatever optional gear may be required. The Escort's case provides latches for mounting for speakers, multiple handles for various carrying options, and wheels for easy transport. Please read these instructions carefully and enjoy your new Peavey Escort 3000.

Features:

- Convenient package with luggage-style wheels
- Two-way speaker system with 10" woofer and piezoelectric horn
- Seven-channel powered mixer
- USB MP3 playback
- High quality digital effects
- 6x XLR - 1/4" combination inputs
- Stereo RCA, 3.5mm, and USB media inputs for media playback
- Seven-band graphic EQ with FLS
- Two folding speaker stands
- 2x 15' speaker cables
- Storage compartments for microphones, cables, etc.
- Footswitchable effects defeat
- PV microphone and cable*
- Mixer stand*

* Indicates optional features. Available on certain models

Setup Guide

THINK SAFETY FIRST!



Much of the setup of the Escort® is similar to the setup of other sound systems, and many aspects require plain common sense. Safety should always be your first concern. Always use grounded outlets and three-wire extension cords. Run sound system cables in a way to prevent the danger of tripping and tape them down if needed. Place the speaker stands and mixer on a solid, level surface. Following these guidelines will help prevent personal injury and equipment damage, ensuring years of trouble-free use.

Setting Up Mixer and Speakers

Place closed unit so speakers are upward. Release latches by lifting up until the latch disengages. Remove the speakers from the case.

NOTE: The latches can be closed after speakers are removed. This is recommended to avoid interference with removal of other components. This will also help avoid damage to the latches. Close the latch by pushing in until it is flush with the side of the case, then push down until it locks.

Remove the speaker stands from the case. Be sure the legs on the stand are fully extended to provide a stable base for the speakers and are positioned on a level surface. Tighten the thumbscrew on the base so that it is snug, but do not overtighten (Fig.1). Raise the speaker stands to the desired height, tighten the thumbscrew and install the safety pin as shown (Fig.2).

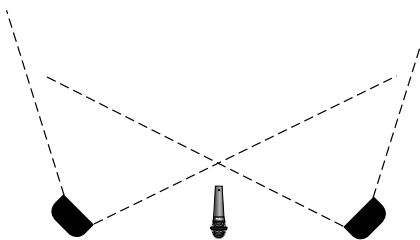

Fig. 1



Fig. 2

Place speakers on stands and position them so that they will face toward the audience and away from the microphones (Fig.3). Connect speaker cables from the jack on the lower front of the speaker to the speaker outputs on the back of the mixer. Connect the left speaker to the LEFT OUTPUT and the right speaker to the RIGHT OUTPUT (Fig.4).



OR

Fig. 3

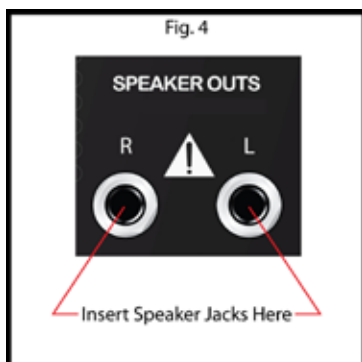
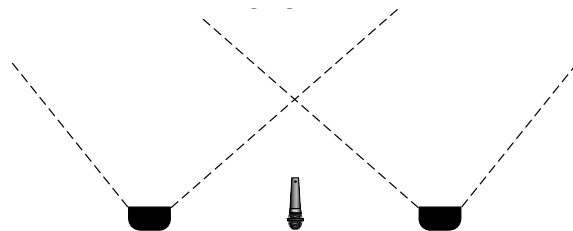

WARNING! Only connect the included speakers to the mixer. Escort speakers provide optimal load for the powered mixer and using other speakers may result in equipment damage.

Connecting Microphone(s) or Line Input(s)

The Escort's powered mixer is designed to work with any good-quality, balanced, dynamic or condenser microphone such as Peavey's PV®i series of microphones. Connect the microphone to the XLR (three-pin) input connector as shown (Fig.5). If using multiple microphones, connect them in the order they will be on stage for easy adjustment to each microphone. To connect a line level device such as a keyboard, use a 1/4" instrument cable and insert into the center of the XLR-1/4" combo connector as shown (Fig.6).

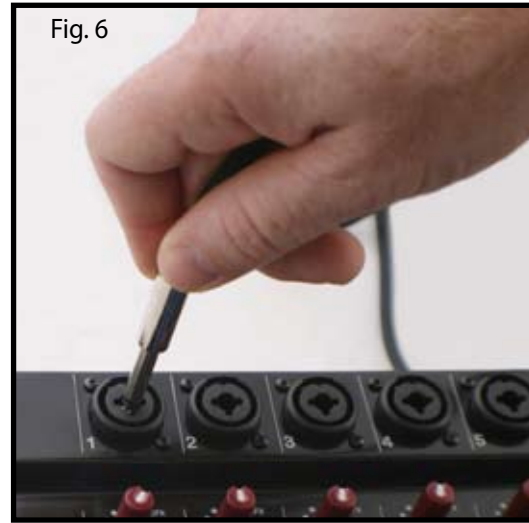

Connecting Media Playback Sources

The Escort powered mixer will accept various media playback devices. For connecting CD player or grounded record player use the CHANNEL 7 RCA Left and Right connections. For connecting an MP3 player or smartphone with media playback use the 3.5mm stereo connector. This will require a stereo 3.5 mm cable (03007820) which can be found at your local Peavey dealer. When using a USB memory stick with MP3 or other audio files stored on it, insert the memory stick into the USB connector on CHANNEL 7 and use the screen and controls in the master section to navigate and play back audio files (Fig.7).

Connecting Power



WARNING! Before connecting power make sure the power switch is in the OFF position.

Connect the IEC power cord to the receptacle on the back panel of the unit as shown (Fig.8), and then to a suitable electrical outlet. If an extension cord is required, make sure it is a three-wire cord with an intact ground pin to preserve the safety ground.

NOTE: FOR UK ONLY

As the colours of the wires in the mains lead of this apparatus may not correspond with the coloured markings identifying the terminals in your plug, proceed as follows:

- (1) The wire that is coloured green and yellow must be connected to the terminal that is marked by the letter E, or by the Earth symbol, or coloured green or green and yellow.
- (2) The wire that is coloured blue must be connected to the terminal that is marked with the letter N, or the colour black.
- (3) The wire that is coloured brown must be connected to the terminal marked with the letter L, or the colour red.

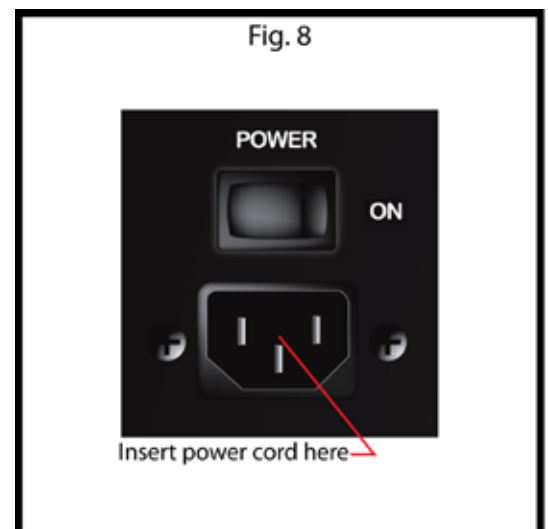
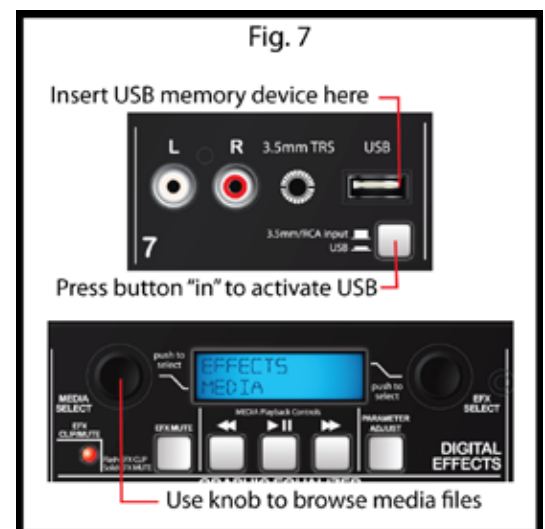

Basic Operation:

Setting Controls and Turning Unit On

Before turning on power, make sure all speakers, microphones, and other input devices are connected. Set Master section controls to the 12 o'clock position and all other controls all the way down, (rotated fully to the left). Turn power on by placing the ON/OFF switch located on the back of the mixer (Fig.9) in the ON position.

Fig. 9



Flip switch to right for "on" position

Adjusting Gain and Volume Controls

The optimal setting for the powered mixer and included speakers is marked on the MASTER LEVEL control (Fig.10). Adjust the CHANNEL LEVEL control (Fig.11) until the desired volume is achieved. If the desired volume is reached with the CHANNEL LEVEL turned down to one of the first three positions, turn the MASTER LEVEL down so you can turn the CHANNEL LEVEL up. If the desired volume is achieved when the CHANNEL LEVEL is close to max then raise the MASTER LEVEL so you can lower the CHANNEL LEVEL. These are the same as any basic mixer functions.

Fig. 10



Open circles indicate optimal range

Adjusting Tone Controls

For each active channel adjust the HIGH, MID-MORPH®, and LOW controls to achieve desired sound (Fig. 11). Use moderation when making these adjustments, as extreme high settings of any of these controls can lead to a distortion of the sound and an increased chance of feedback on microphone inputs.

HIGH

This High EQ shelving type of active tone control varies the treble frequencies (+/- 15dB at 12kHz) and is designed to remove noise or add brilliance to the signal, depending on the quality of the source.

MID-MORPH

Where most mid-range controls work at just one frequency, the Mid-Morph works at two. When turned to the left, it cuts at 250 Hz to reduce frequencies that muddy the sound. When turned to the right, it boosts at 4 kHz to add intelligibility to vocals. Either way, improved vocal or instrument definition can be achieved.

LOW

A shelving type of EQ that varies the bass frequency levels (+/- 15dB at 80Hz). Low EQ adds depth to thin-sounding signals or cleans up the muddy ones. As with any EQ, use sparingly. Too much of this EQ can give you a booming bottom end.

Fig. 11



Tone Controls

Channel Level Control

Effects:

Adjusting Effect Settings

The Escort has built-in digital effects. These effects can be selected in the MASTER section by turning the EFFECTS SELECT knob left or right until the desired effect is shown on the display (Fig.12). Once the desired effect is displayed on the screen push the knob in to select and activate the effect. To adjust the effect parameter simply press the PARAMETER ADJUST button (Fig.12) the available parameter and its adjustments will be shown on the display. Turn the EFFECTS SELECT knob left or right to adjust the parameter then press the PARAMETER ADJUST button or the EFFECTS SELECT knob to return to the effects select screen. To hear more or less of the effect, on any given channel, turn the CHANNEL EFX knob to the left to hear less of the effect, and to the right to hear more of the effect (Fig.13). The EFX MUTE button in the master section (Fig.12) will mute the effects on all channels. There are no effects on the media channels.

Footswitchable Effects Defeat

Your new Escort has a footswitchable effects defeat. This allows the user to mute the effects on all channels by use of a single button footswitch such as the Peavey Momentary Single-Button Switch (03050680) which can be purchased at your local Peavey dealer. Insert the 1/4" plug from the footswitch into the EFFECTS DEFEAT jack on the rear of the Escort mixer (Fig.14). Once connected, pressing the footswitch button will toggle the EFX MUTE (Fig.12).

Available Effects and Parameters

| ON SCREEN NAME | EFFECT | AVAILABLE PARAMETER |
|------------------|----------------------------------|---------------------|
| 1 REV Plate Br1 | Plate Reverb Bright | Time |
| 2 REV Plate Br2 | Plate Reverb Gentle Low-Pass | Time |
| 3 REV Plate Med | Plate Reverb Medium Low-Pass | Time |
| 4 REV Plate Dk1 | Plate Reverb Hard Low-Pass | Time |
| 5 REV Plate Dk2 | Plate Reverb Dark | Time |
| 6 REV Vocal | Hall Reverb Vocal | Time |
| 7 REV Vocal Big | Hall Reverb Vocal Huge | Time |
| 8 REV Vox Warm | Hall Reverb Vocal Glow | Time |
| 9 REV Strings | Hall Reverb Strings | Time |
| 10 REV Lg Brass | Hall Reverb Brass Hall | Time |
| 11 REV Vox Air | Room Reverb Vocal Air | Time |
| 12 REV Vox Club | Room Reverb Vocal Club | Time |
| 13 REV Snare | Room Reverb Snare Low | Time |
| 14 REV Ac Guitar | Room Reverb Acoustic Guitar | Time |
| 15 REV Sm Brass | Room Reverb Brass | Time |
| 16 ENH Tube | Enhancer Tube Distortion | Brightness |
| 17 ENH Vocal 1 | Vocal Enhancer Vox | Brightness |
| 18 ENH Vocal 2 | Vocal Enhancer Vox Medium | Brightness |
| 19 DLY Double | Delay Double | Time |
| 20 DLY Slap | Delay Slapback | Time |
| 21 DLY BRT 1 | Delay Bright, Few Repeats | Time |
| 22 DLY BRT 2 | Delay Bright, More Repeats | Time |
| 23 DLY BRT 3 | Delay Bright, Most Repeats | Time |
| 24 DLY Dark 1 | Delay Dark, Few Repeats | Time |
| 25 DLY Dark 2 | Delay Dark, More Repeats | Time |
| 26 DLY Dark 3 | Delay Dark, Most Repeats | Time |
| 27 CHO Deep Slow | Chorus High Depth, Slow Rate | Rate |
| 28 CHO Mod Wide | Chorus Moderate Depth, Wide Rate | Rate |
| 29 CHO Shrt Wide | Chorus Short Depth, Wide Rate | Rate |
| 30 CHO Shrt Fast | Chorus Short Depth, Fast Rate | Rate |
| 31 CHO Deep Mod | Chorus High Depth, Moderate Rate | Rate |

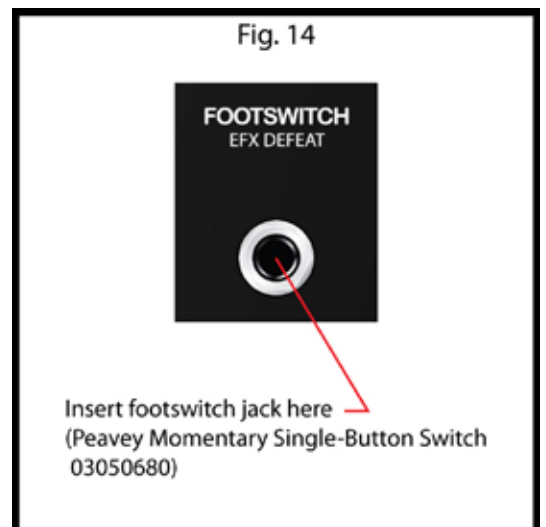
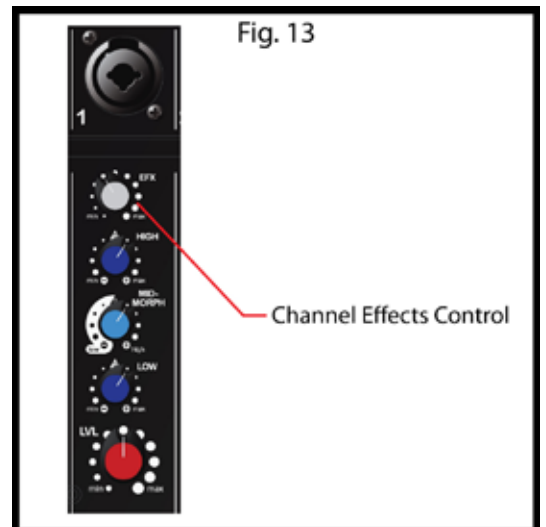
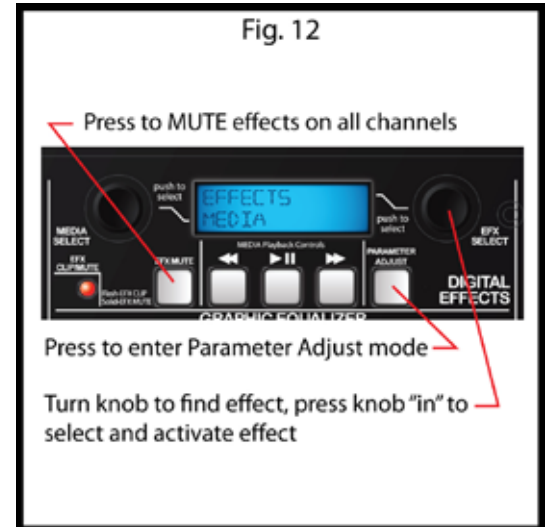

MEDIA:

Playback from Media Source

Hook up your media source device as mentioned previously. When using RCA jacks for a CD player, record player, or tape machine make sure the button is in the raised position so these jacks are active (Fig.15). Which inputs are active will also be displayed on the screen in the master section. Use the controls on the source device for play, stop, forward and reverse functions. Adjust channel 7 controls on the Escort mixer for desired sound. For media playback using an MP3 player, smartphone, or other similar device make sure the button stays in the raised position. Connect using a stereo 3.5mm cable mentioned previously and use the source device for playback controls. When a device is connected to the 3.5mm jack the RCA jacks are automatically disabled. For MP3 or audio file playback from a USB memory stick, make sure the button is in the down position (Fig.16) so the USB plug is active.

NOTE: The Escort does not allow playback through multiple media inputs simultaneously.

With your USB device attached, use the MEDIA SELECT knob (Fig.17) to navigate through your audio files. Once the desired file is displayed on the screen press the MEDIA SELECT knob to cue that file. Use the controls on the mixer for play, pause, forward and reverse. If you do not choose to navigate or select a certain file the Escort will play the files in the order they are stored on your USB memory device.

Non-audio files will show up in your navigation but will have no audio playback if selected. Only audio files can be selected for playback.

Supported Audio File Types

.WAV
.MP3
.WMA

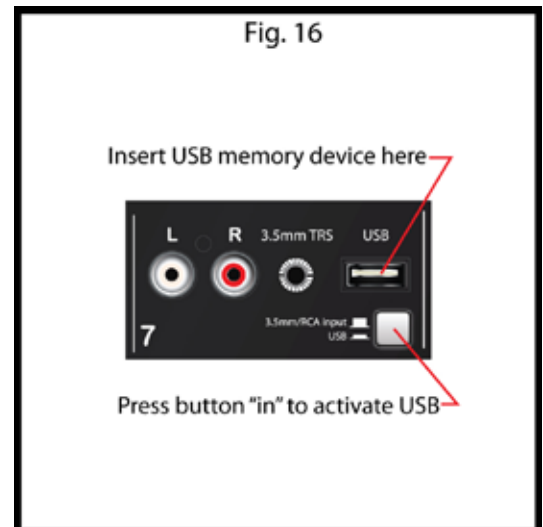
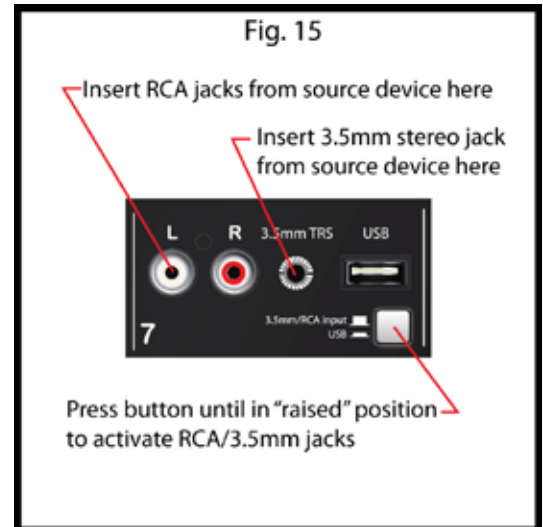

EQUALIZATION:

Using the Graphic Equalizer

Unlike the HIGH, MID-MORPH, and LOW controls on each channel that adjust only the tone of their own input signals, the seven-band graphic equalizer adjusts the tonal balance of all the signals going through the powered mixer. This graphic equalizer is also a powerful tool to help reduce or eliminate acoustic feedback. This offers the user great flexibility in adjusting the sound, but use moderation in making these adjustments.

FLS® Feedback Locating System

The FLS (Feedback Locating System) LED indicators are invaluable tools in helping to reduce/eliminate feedback. Acoustic feedback is the loud howl or squealing sound heard through sound systems as the result of sound from the speakers re-entering the microphones. To use the FLS feature, start by setting all graphic EQ sliders (Fig.18) to 0. Then before the audience arrives, increase the MASTER LEVEL and/or CHANNEL LEVEL until feedback occurs. Note which LED illuminates and slightly lower the corresponding slider. This reduces gain at the feedback frequency and can be repeated if necessary to improve gain before feedback. Only adjust the sliders a small amount to avoid adversely affecting sound quality.

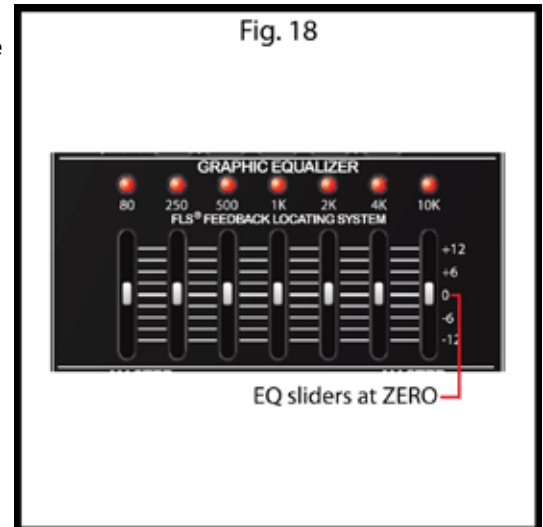

GENERAL USE TIPS:

Avoiding Acoustic Feedback

When encountering feedback it is always best to start looking at the placement of the mics and speakers in the system before resorting to equalization (EQ) adjustments. Make sure that the speakers are positioned to direct the sound toward the audience and away from the microphones. Position mics as close to the sound source as reasonable. Moving the mic closer increases the volume of the sound through the system without having to turn up the gain.

Microphone Usage Guidelines

When practical, a single microphone is preferred. Additional microphones pick up more sound from the speakers and each mic must then be turned down to prevent feedback. However, if you have difficulty balancing the level of different individuals with one mic or if you still cannot get sufficient gain, using more mics can offer an advantage. For example, giving several singers their own microphone allows placement of the microphones much closer to each singer. This increases the volume of the sound at the mic and far outweighs any detrimental effect from using multiple mics. It also allows the volume of each mic to be adjusted separately for proper balance.

Packing the Escort®

One of the Escort's many benefits is that the entire sound system can be packed inside its easily transportable case (Fig.19). Begin by folding the speaker stands, then secure them into their storage compartment using the two straps. Place the optional microphone(s) in their storage compartment, putting the cables in the other compartment or with the speaker stands. Lay the speakers face down on top of the bottom tray and secure the four latches. The Escort is now ready to be carried or pulled on its built-in, luggage-style wheels.

Fig. 19



OPTIONS:

Optional Accessories (available from local Peavey dealer)

Microphone Stands - Tripod mic stand with boom (00722910)

Additional Microphones and Cables - PVi® 2 mic with cable included (00496360)

Microphone Wind Screens - Black wind screen (00069100)

Additional Speaker Cables in Various Lengths - 25' 16 AWG (00060450)

Additional Speaker Stands in Various Sizes - Black Speaker Stand (00722890)

Audio Cables for CD Player, Record Player, Tape Machine, or MP3 Player/Smartphone Hook-up

Optional Mixer Stand Assembly (00496340)

Remove the mixer stand from the case. The mixer stand consists of three parts: two pairs of legs and the stand cross-members (Fig.20). Hold the stand cross-member with the leg sockets together as shown (Fig.21). Fully insert one set of legs into the cross-members (Fig.22). Still holding the cross members together, set the legs on the floor and insert the second pair of legs. If you need to move the stand, carry it folded by holding the legs.



WARNING: For safety, be sure to fully open the mixer stand and place it on a stable, level surface.

Fig. 20



Fig. 21

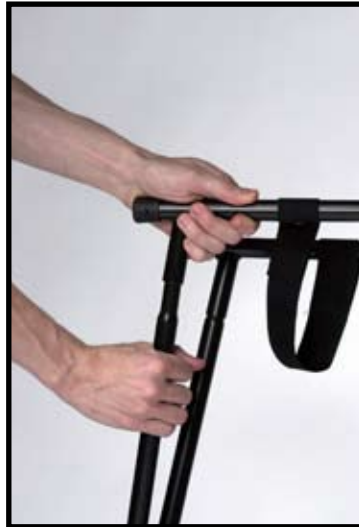

Fig. 22



Escort® 3000 Troubleshooting Guide

| Problem | Check | Correction |
|-----------------------------------------------|---------------------------------------------------------------------------------------------------------------|-----------------------------------------------------------------------------------------------------------------------------------------------------------------------------------------------------------------------------------------------|
| No sound (LCD not lit) | Is power switch on? Is line cord connected to live power outlet? | Turn power switch on Connect power cord to live outlet |
| No sound (LCD not lit) | Are MASTER and CHANNEL GAIN controls up? | Adjust both MASTER and CHANNEL LEVEL controls upward to desired level. Check speaker connections. Turn mic switch on. Check mic or sound source connection. |
| No Effects | Are the channel EFX controls turned up? Is the master EFX MUTE enabled? Is an effect activated in menu? | Make sure desired effect is selected in Master effect menu. Check the master EFX MUTE. If the LED is illuminated the EFX MUTE is active. Press the EFX MUTE button once to disable. Adjust channel EFX control until audio effect is heard. |
| Files on USB memory device will not play back | Is the file cued for playback? Are the audio files the proper format? | Make sure once MEDIA SELECT knob is rotated to display desired file the knob is then pressed to cue the file. Make sure your audio files are the correct format. See the list of supported audio formats mentioned previously in this manual. |
| Loud howling or squeal from speakers | If it goes away when the CHANNEL or MASTER LEVEL controls are turned down, then it is acoustic feedback. | Reduce microphone gain. Reposition microphone behind or farther from speakers. Observe FLS light above EQ and reduce level of corresponding slider. |
| Sound is distorted | Is the CHANNEL GAIN at a very high setting? | Reduce CHANNEL GAIN and increase MASTER VOLUME |

Escort® 3000 Specifications:

| | |
|----------------------------------------|------------------------------------------------------------------------------------------|
| Output Power: | 80 watts RMS (per channel) |
| Frequency Response: | 40 Hz to 20 kHz +/-3 dB |
| Overload Protection: | 10 dB of DDT™ that limits the PA output to prevent clipping that can damage the speakers |
| Distortion: | Less than 0.2% THD @ Max power |
| Signal/Noise Ratio: | 88 dB mic input typical |
| AC Power: | 115 V AC 60 Hz or 230 V AC 50/60 Hz |
| Weight Assembled: (stands included) | 50 lbs. (22.67 kg) |
| Dimensions: | 14.5" H x 36.75" W x 15.5" D (36.8 cm x 93.3 cm x 39.4 cm) |
| Speakers: | Woofer 10" (254 mm) Piezoelectric Horn Tweeter |

NOTES

Handwritten notes on lined paper.

Optional Product Extended Warranty Registration

Give us some information and put your extended warranty into effect!

Please take a few minutes to fill out this information/survey sheet to help us get to know and serve you better.
To save time, submit your warranty registration online at www.peavey.com/support/warrantyregistration

1.

First Name _____ Initial _____ Last Name _____

Street Address _____

City _____ State/Province _____ Postal Code _____

() _____
Telephone Number _____ E-mail Address _____

() _____
Fax Number _____ Date of birth _____

Gender M F

2.

Model _____ 8-Digit Serial Number

Date of Purchase _____ Price Paid _____

3.

Name of store where purchased _____

City _____ State _____

4. Top two (2) reasons why you purchased from this store/dealer:

- | | |
|-----------------------------------------------------------|----------------------------------------------------|
| <input type="checkbox"/> Availability of product | <input type="checkbox"/> Past favorable experience |
| <input type="checkbox"/> Friend/Relative's recommendation | <input type="checkbox"/> Best price |
| <input type="checkbox"/> Store credit card | <input type="checkbox"/> Advertised special |
| <input type="checkbox"/> Knowledgeable staff | <input type="checkbox"/> Convenient location |
| <input type="checkbox"/> Availability of lessons | <input type="checkbox"/> Received as a gift |
| <input type="checkbox"/> Technical instruction | <input type="checkbox"/> Other _____ |

5. Where do you most often shop for music and sound products?

- | | |
|-----------------------------------------------|---------------------------------------------|
| <input type="checkbox"/> Independent retailer | <input type="checkbox"/> Newspaper ads |
| <input type="checkbox"/> Mass market retailer | <input type="checkbox"/> Internet/Web sites |
| <input type="checkbox"/> Mail order magazines | <input type="checkbox"/> Other _____ |

6. What two (2) factors most influenced your purchase of this product?

- | | |
|----------------------------------------------|-------------------------------------------------------|
| <input type="checkbox"/> Peavey brand name | <input type="checkbox"/> Product appearance |
| <input type="checkbox"/> Craftsmanship | <input type="checkbox"/> Durability |
| <input type="checkbox"/> Features for price | <input type="checkbox"/> Prior experience with Peavey |
| <input type="checkbox"/> Bundled accessories | <input type="checkbox"/> Packaging |
| <input type="checkbox"/> Sound quality | <input type="checkbox"/> Other _____ |

15. In your opinion, what could Peavey do to improve its products and/or service? Please use the space below to tell us your answer.

7. How did you learn about this Peavey product? (select best answer)

- | | |
|-----------------------------------------------------------|---------------------------------------------------|
| <input type="checkbox"/> Magazine review | <input type="checkbox"/> Teacher's recommendation |
| <input type="checkbox"/> Newspaper review | <input type="checkbox"/> Catalog or flyer |
| <input type="checkbox"/> Radio advertisement | <input type="checkbox"/> Saw in store |
| <input type="checkbox"/> Advertised special | <input type="checkbox"/> Use by professional |
| <input type="checkbox"/> Friend/Relative's recommendation | <input type="checkbox"/> Other _____ |
| <input type="checkbox"/> Salesperson's recommendation | |

8. Which other brands/models did you consider?

9. How would you describe your level of musicianship/technical expertise?

- Beginner - Never played or taken less than one (1) year of lessons
- Intermediate - One (1) to five (5) years of lessons or playing
- Advanced - More than five (5) years of lessons or playing; play professionally

10. Education: (select best answer)

- High school
- Some college
- Completed college
- Graduate school

11. Which best describe your family income? (select best answer)

- | | |
|----------------------------------------------|------------------------------------------------|
| <input type="checkbox"/> Under \$15,000 | <input type="checkbox"/> \$75,000 - \$99,999 |
| <input type="checkbox"/> \$15,000 - \$24,999 | <input type="checkbox"/> \$100,000 - \$149,999 |
| <input type="checkbox"/> \$25,000 - \$34,999 | <input type="checkbox"/> Over - \$150,000 |
| <input type="checkbox"/> \$35,000 - \$49,999 | |
| <input type="checkbox"/> \$50,000 - \$74,999 | |

12. Which of the following is your primary source of information on musical products: (select best answer)

- | | |
|-------------------------------------|-------------------------------------------------------|
| <input type="checkbox"/> Television | <input type="checkbox"/> Mail order catalogs |
| <input type="checkbox"/> Radio | <input type="checkbox"/> Direct mail |
| <input type="checkbox"/> Internet | <input type="checkbox"/> Literature from manufacturer |
| <input type="checkbox"/> Newspaper | <input type="checkbox"/> Other _____ |
| <input type="checkbox"/> Magazines | |

13. What is your main motivation for buying new equipment?

- | | |
|--------------------------------------------------------------|--------------------------------------------------------|
| <input type="checkbox"/> Replacing old product | <input type="checkbox"/> Impulse |
| <input type="checkbox"/> Want new and leading edge equipment | <input type="checkbox"/> Need for improved performance |
| <input type="checkbox"/> Fulfill a specific need | <input type="checkbox"/> New technology |
| <input type="checkbox"/> Supplement existing products | <input type="checkbox"/> Availability of product |
| <input type="checkbox"/> Value | <input type="checkbox"/> Other _____ |

14. Please list your three most frequently visited Web sites.

1. http:// _____
2. http:// _____
3. http:// _____



FROM:



**Peavey Electronics
Corporation**
Attn: Warranty Department
P.O. Box 5108
Meridian, Ms 39302-5108

Place
Postage
Here

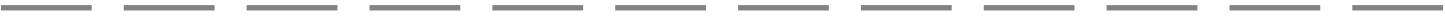

PEAVEY ELECTRONICS CORPORATION LIMITED WARRANTY

Effective Date: 09/15/2010

What This Warranty Covers

Your Peavey Warranty covers defects in material and workmanship in Peavey products purchased and serviced in the U.S.A. and Canada.

What This Warranty Does Not Cover

The Warranty does not cover: (1) damage caused by accident, misuse, abuse, improper installation or operation, rental, product modification or neglect; (2) damage occurring during shipment; (3) damage caused by repair or service performed by persons not authorized by Peavey; (4) products on which the serial number has been altered, defaced or removed; (5) products not purchased from an Authorized Peavey Dealer.

Who This Warranty Protects

This Warranty protects only the original purchaser of the product.

How Long This Warranty Lasts

The Warranty begins on the date of purchase by the original retail purchaser. The duration of the Warranty is as follows:

| Product Category | Duration |
|-------------------------------------------------------------------------------------------------------------|----------------------|
| Guitars/Basses, Amplifiers, Preamplifiers, Mixers, Electronic Crossovers and Equalizers | 2 years *(+ 3 years) |
| Drums | 2 years *(+ 1 year) |
| Enclosures | 3 years *(+ 2 years) |
| Digital Effect Devices and Keyboards and MIDI Controllers | 1 years *(+ 1 year) |
| Microphones | 2 years |
| Speaker Components (incl. Speakers, Baskets, Drivers, Diaphragm Replacement Kits and Passive Crossovers) | 1 year |
| Tubes and Meters | 90 Days |
| Cables | Limited Lifetime |
| AmpKit Link, Xport, Rockmaster Series, Strum'n Fun, RetroFire, GT & BT Series Amps | 1 year |

[* Denotes additional Warranty period applicable if optional Warranty Registration Card is completed and returned to Peavey by original retail purchaser within 90 days of purchase.]

What Peavey Will Do

We will repair or replace (at Peavey's discretion) products covered by Warranty at no charge for labor or materials. If the product or component must be shipped to Peavey for Warranty service, the consumer must pay initial shipping charges. If the repairs are covered by Warranty, Peavey will pay the return shipping charges.

How To Get Warranty Service

(1) Take the defective item and your sales receipt or other proof of date of purchase to your Authorized Peavey Dealer or Authorized Peavey Service Center.

OR

(2) Ship the defective item, prepaid, to Peavey Electronics Corporation, International Service Center, 412 Highway 11 & 80 East, Meridian, MS 39301. Include a detailed description of the problem, together with a copy of your sales receipt or other proof of date of purchase as evidence of Warranty coverage. Also provide a complete return address.

Limitation of Implied Warranties

ANY IMPLIED WARRANTIES, INCLUDING WARRANTIES OF MERCHANTABILITY AND FITNESS FOR A PARTICULAR PURPOSE, ARE LIMITED IN DURATION TO THE LENGTH OF THIS WARRANTY.

Some states do not allow limitations on how long an implied Warranty lasts, so the above limitation may not apply to you.

Exclusions of Damages

PEAVEY'S LIABILITY FOR ANY DEFECTIVE PRODUCT IS LIMITED TO THE REPAIR OR REPLACEMENT OF THE PRODUCT, AT PEAVEY'S OPTION. IF WE ELECT TO REPLACE THE PRODUCT, THE REPLACEMENT MAY BE A RECONDITIONED UNIT. PEAVEY SHALL NOT BE LIABLE FOR DAMAGES BASED ON INCONVENIENCE, LOSS OF USE, LOST PROFITS, LOST SAVINGS, DAMAGE TO ANY OTHER EQUIPMENT OR OTHER ITEMS AT THE SITE OF USE, OR ANY OTHER DAMAGES WHETHER INCIDENTAL, CONSEQUENTIAL OR OTHERWISE, EVEN IF PEAVEY HAS BEEN ADVISED OF THE POSSIBILITY OF SUCH DAMAGES.

Some states do not allow the exclusion or limitation of incidental or consequential damages, so the above limitation may not apply to you.

This Warranty gives you specific legal rights, and you may also have other rights which vary from state to state.

If you have any questions about this Warranty or services received or if you need assistance in locating an Authorized Service Center, please contact the Peavey International Service Center at (601) 483-5365.

Features and specifications are subject to change without notice.



Logo referenced in Directive 2002/96/EC Annex IV (OJ(L)37/38,13.02.03 and defined in EN 50419: 2005
The bar is the symbol for marking of new waste and is applied only to equipment manufactured after 13 August 2005



Features and specifications subject to change without notice.

Peavey Electronics Corporation • 5022 Hartley Peavey Dr. • Meridian, MS 39305
(601) 483-5365 • FAX (601) 486-1278 • www.peavey.com